



# ILLUSTRATED PARTS BREAKDOWN

# B213F EXPANDER

## HOW TO USE THE IPB

### GENERAL

This IPB is compiled following the organization and nomenclature of the engineering drawing structure.

### MAJOR ASSEMBLY LOCATOR (When Applicable)

The Major Assembly Locator (first illustration) is an index that provides a description and a figure reference for all illustrations used in this manual.

### INDENTED PARTS LIST

This manual identifies each assembly being broken down (figure reference callout), and all parts of that assembly. Further breakdown of an assembly is shown by an asterisk (\*) preceding the item callouts in the Description Column. The number of asterisks preceding an item is used to denote the subordination of that item with respect to the Major Assembly. A single asterisk preceding an item description indicates that the item is part of the major assembly being illustrated. Items that are subordinate to single asterisks items, are denoted by two asterisks (\*\*) and immediately follow the related single asterisk item. This system of part identification provides a means for the user to identify the next higher assembly item and make alternate selections for parts when the required replacement part of assembly is not immediately available.

### COLUMN CALLOUT DESCRIPTION

**Figure and Item** - Indicates the figure number and item number of each part

**Description** - Lists the name of the part and pertinent specifications (when required). Asterisks preceding the description denote the subordination of the part to the next higher assembly.

**DEC Part No.** - Lists the Digital part ordering number. A blank in this column indicates a Digital part number was not assigned at the time of publication.

**ECO Cut-In** - The notation at the top of this column indicates the ECO level of the system (option), at which the IPB was initially prepared. Subsequent ECO level designations, that modify existing parts or add new parts to the device, are inserted in the ECO Cut-In column next to the part that is added or modified.

**Used On Code** - Letters in this column correspond to the variation codes assigned in Figure 1. Parts with an Alpha notation(s) are used only in those option variations. A blank indicates that the part is used on all option variations.

**Ref Fig No.** - A cross reference between illustrations. For each Major Assembly, the number in this column denotes the figure of the next higher assembly. For all subassemblies, the number in this column denotes the figure showing additional detailed breakdown.

**PART NUMBER/PART DESCRIPTION INDEX SECTION**  
Parts are sorted both numerically and alphabetically by description, referenced to a location within the IPB, by figure number and item number.

## REVISION HISTORY

PRINTING	ECO LEVEL		DATE	OTHER IPB MANUALS REFERENCED
3rd Printing	B213F	00000-00001	24-AUG-90	EK-BA213-IP EK-BA400-IP EK-400ST-IP
	70-24227	00002-00008		
	70-24037	00001-00004		
	70-24041	00000-00000		
	70-24046	00001-00002		
	70-25752	00001-00003		
	RF30	00000-00000		
	RF30E-S	00000-00000		
	RF31	00000-00000		
	RF31E-S	00000-00000		
	RF71	00000-00000		
	RF71E-A	00000-00000		
	RF71E-S	00001-00001		

Digital Equipment Corporation reserves the right, without notice, to make substitutions and modifications in the specifications of products documented in this manual and further reserves the right to withdraw any of these products from the market without notice.

Digital Equipment Corporation is not responsible for errors which may appear in the technical description (including illustrations and photographs) of the products covered by this manual.

None of the descriptions contained in this manual imply the granting of any license whatsoever to make, use or sell equipment constructed in accordance therewith.

Restricted Rights: Use, duplication or disclosure by the U.S. Government is subject to restrictions as set forth in subparagraph (c) (1) (ii) of the Rights in Technical Data and Computer Software clause at DFARS 252.227-2713.

Copyright © 1989, 1990 by Digital Equipment Corporation. All rights reserved.

The postage-paid READER'S COMMENTS form on the last page of this document requests your critical evaluation to assist us in preparing future documentation.

The following are trademarks of Digital Equipment Corporation :

---

The logo consists of the word "digital" in a lowercase, sans-serif font, with a small "TM" trademark symbol to its upper right. The text is white and set against a dark, rectangular background.

DEC  
DECUS  
DECsystem  
PDP  
UNIBUS  
VAX  
DSSI  
KA640  
MicroVAX  
Q-Bus  
SDI

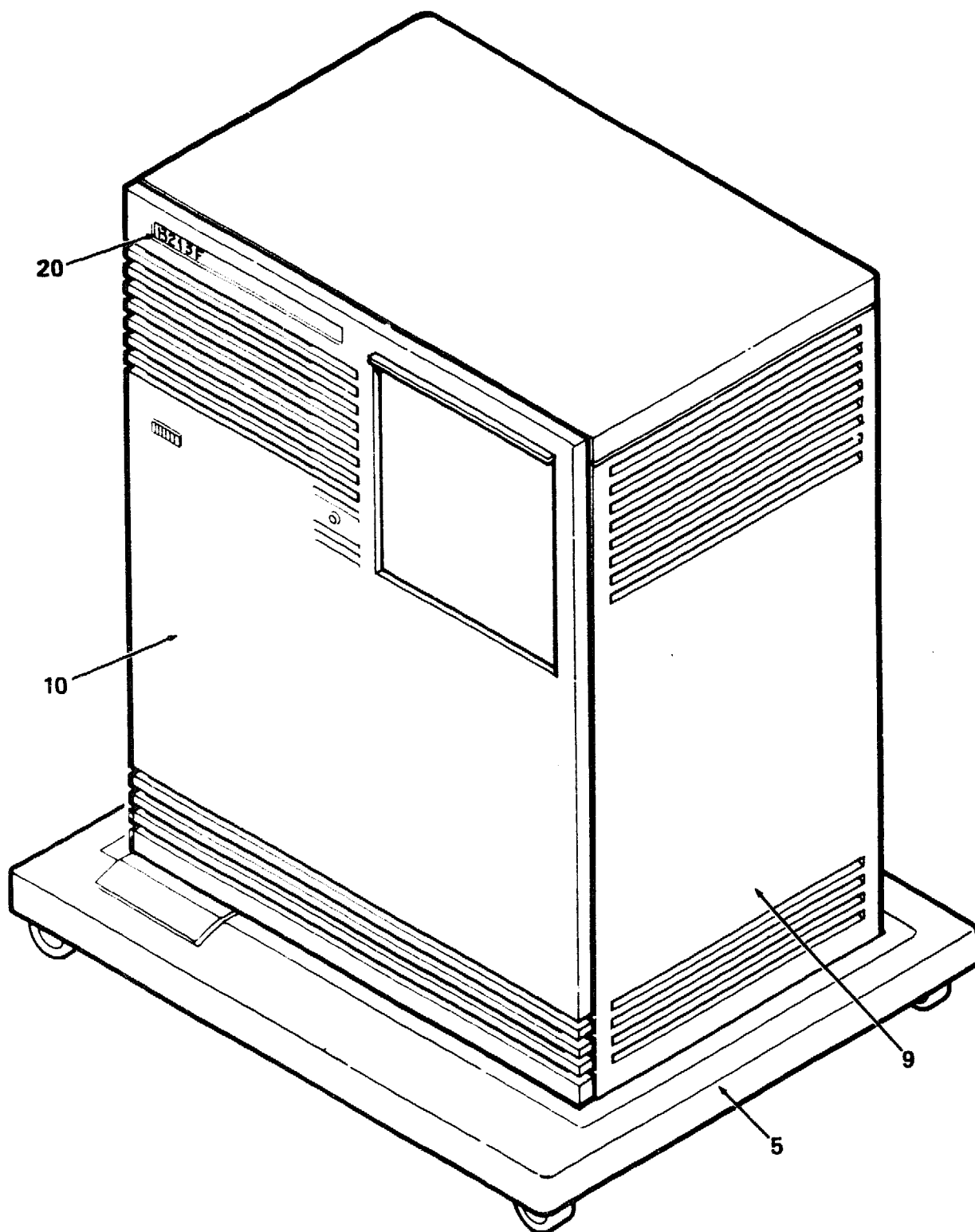

B213F-01-BD

**Figure 1. B213F Expander (Sheet 1 of 2)**



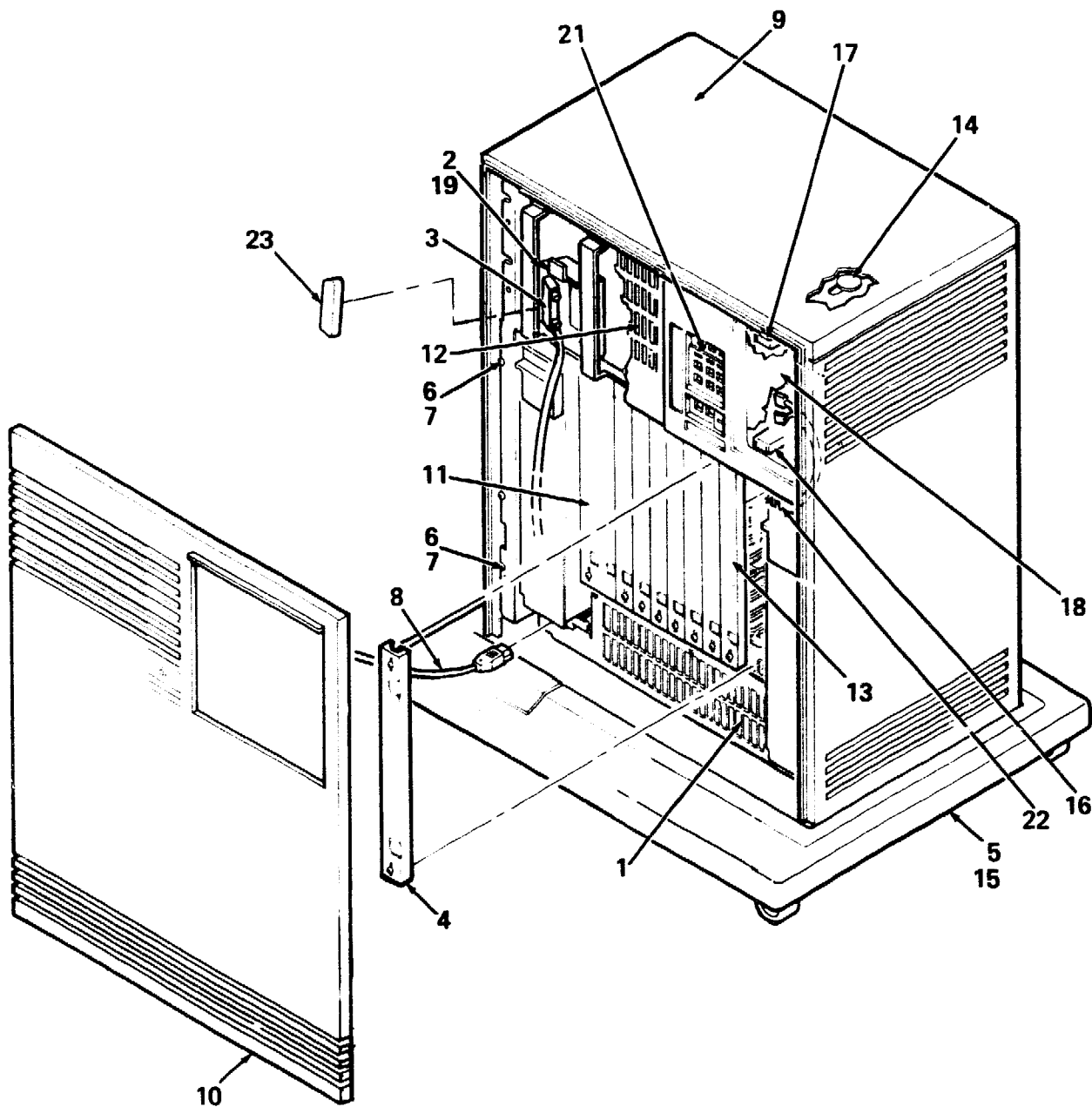

B213F-01A-BD

Figure 1. B213F Expander (Sheet 2 of 2)

FIG. & ITEM NO.	DESCRIPTION	DEC PART NO.	ECO CUT-IN B213F 00000	USED ON CODE	REF FIG NO.
1-	B213F EXPANDER				
	Code A - Used on B213F-A2 2 PS 120V w/o Skins	B213F-A2		A	
	Code B - Used on B213F-A3 2 PS 240V w/o Skins	B213F-A3		B	
	Code C - Used on B213F-B2 2 PS 120V w/Skins	B213F-B2		C	
	Code D - Used on B213F-B3 2 PS 240V w/Skins	B213F-B3		D	
1	*ENCLOSURE ASSEMBLY, BA213 2 PS (120V)	70-24227-03		AC	1A
	*ENCLOSURE ASSEMBLY, BA213 2 PS (240V)	70-24227-04		BD	1A
2	*Plate Assembly, Connector	70-26206-01			
3	*Cable Assembly, DSSI External (BC21M-09)	17-02152-03			
4	*Bulkhead Assembly, Front	70-23981-04			
5	*BASE ASSEMBLY	70-24046-01		CD	4
6	*Screw, Self-Tap Phl Pan Hd No. 8-16 x 1/2	90-09800-08			
7	*Washer, Flat	90-06661-00			
8	*Cord, Power (120V) (BN20A-2E)	17-00083-43		AC	
	*Cord, Power (240V)	17-00365-06		BD	
9	*ENCLOSURE ASSEMBLY, SHELL	70-24037-01		CD	2
10	*PANEL ASSEMBLY, FRONT	70-24041-01		CD	3
11	*Bulkhead, Front Dual	70-23982-02			
12	*Panel Assembly, Front	70-25750-02			
13	*Bulkhead, Front Single	70-23981-01			
14	*Plug, Button	90-07064-00		AB	
15	*Fastener, Turn	74-33854-01		CD	
16	*Shock Assembly, Bottom	70-25452-03			
17	*Shock Assembly, Top	70-25452-04			
18	*Panel, 5 1/4" Tape Drive Filler	74-36425-01			
19	*Screw, Metric	90-01917-01			
20	*Nameplate, B213F	74-34425-37		CD	
21	*OCP ASSEMBLY	70-25752-01			5
22	*Switch, Frame	74-35417-01		CD	
23	*Protector, DSSI Port	12-33902-01			
	ITEMS (Not Shown)				
	*Harness Assembly, 10 Cond (See Note 1)	17-01990-01			
	*Harness Assembly, 10 Cond (See Note 1)	17-01989-01			
	*Cable Assembly, 10 Cond Flat 2 ft (See Note 1)	17-01964-01			
	*Harness Assembly, Wire 18 AWG (See Note 1)	17-01937-01			
	*Cable Assembly, Flat 50 Cond (See Note 1)	17-01836-01			

FIG. & ITEM NO.	DESCRIPTION	DEC PART NO.	ECO CUT-IN B213F 00000	USED ON CODE	REF FIG NO.
1-	KITS (Not Shown)				
	*KIT, ACCESSORIES	70-25807-06		AB	
	**Lens Encoder Set	12-28766-19		AB	
	**Screwdriver	47-00042-00		AB	
	*KIT, ACCESSORIES	70-25807-07		CD	
	**Lens Encoder Set	12-28766-19		CD	
	**Screwdriver	47-00042-00		CD	
	**Keys, Front Panel	12-17119-01			
	LABELS (Not Shown)				
	*Label, "Warning Equipment Rating "100-120V"	36-17905-16		AC	
	*Label, "Warning Equipment Rating "220-240V"	36-17905-17		BD	
	*Label, "Control Panel, R215F"	36-30973-01			
	*Label, "Logo/Model, B213F, Expander Box"	36-27354-27			
	*Label, "Serial/Model 100V"	36-27329-01		AC	
	*Label, "Serial/Model 220V"	36-27329-03		BD	
	*Label, "Pedestal 11/53 USA 100V"	36-27838-01		C	
	*Label, "Pedestal BA213, Made in US"	36-27838-37		D	
	*Label, "Caution S-box Shipping"	36-27924-01			
	ITEMS (Not Shown)				
	*Screw, Sems Phi Pan Hd No.10-32 x 15/16 (See Note 2)	90-09282-00			
	Note 1: See Fig. 6 For Cable Location.				
	Note 2: See Fig. 4 Item 9				

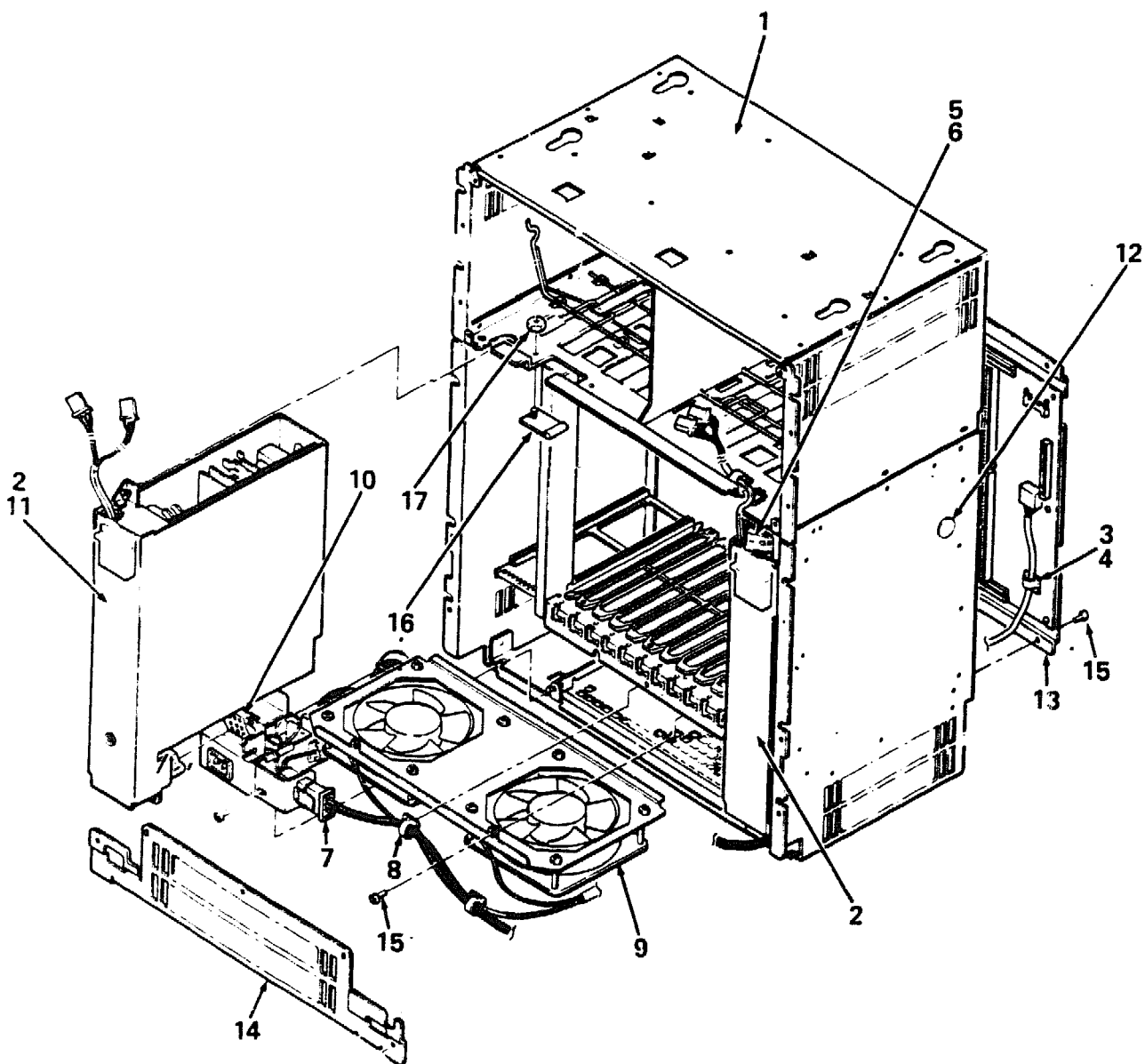

B213F-01B-BD

**Figure 1A. Enclosure Assembly, BA213**

PARTS LIST



FIG. & ITEM NO.	DESCRIPTION	DEC PART NO.	K ECU CUT-IN 7024227 00002	USED ON CODE	REF FIG NO.
1A-	ENCLOSURE ASSEMBLY, BA213 (2 PS 120V) ENCLOSURE ASSEMBLY, BA213 (2 PS 240V)	70-24227-03 70-24227-04		AC BD	1 1
1	*Frame Assembly, BA213 (See IPB Manual EK-BA213-IP)	70-24255-01			
2	*Power Supply Assembly, H7868-A 100/120V *Power Supply Assembly, H7868-B 220/240V (See IPB Manual EK-BA213-IP)	H7868-A H7868-B		AC BD	
3	*Clamp, Cable (deleted)	90-08264-00	00007		
4	*Tie, Cable (deleted)	90-07032-00	00007		
5	*Switch Assembly (See IPB Manual EK-BA213-IP)	70-23999-01			
6	*Nut, Kep No. 6-32	90-08185-00			
7	*Cable Assembly	17-01360-01			
8	*Clip, Wire Routing	12-21249-06			
9	*Fan Assembly (See IPB Manual BA213-IP)	70-23998-01			
10	*Input Assembly, Filter (See IPB Manual EK-BA213-IP)	70-23769-01			
11	*Filler, Power Supply Assembly	70-23996-01			
12	*Plug, Button (added)	90-07064-00	00007		
13	*Backplane Assembly, BA213 (See IPB Manual EK-BA213-IP)	70-23712-01			
14	*Panel Assembly, Access	70-25721-01			
15	*Screw, Self Tap Truss Hd No. 6 x 5/16	90-00063-78			
16	*Plate, Cover (added)	74-37040-01	00003		
17	*Nut, Kep No. 6-32 x 1/4 (added)	90-08185-00	00003		

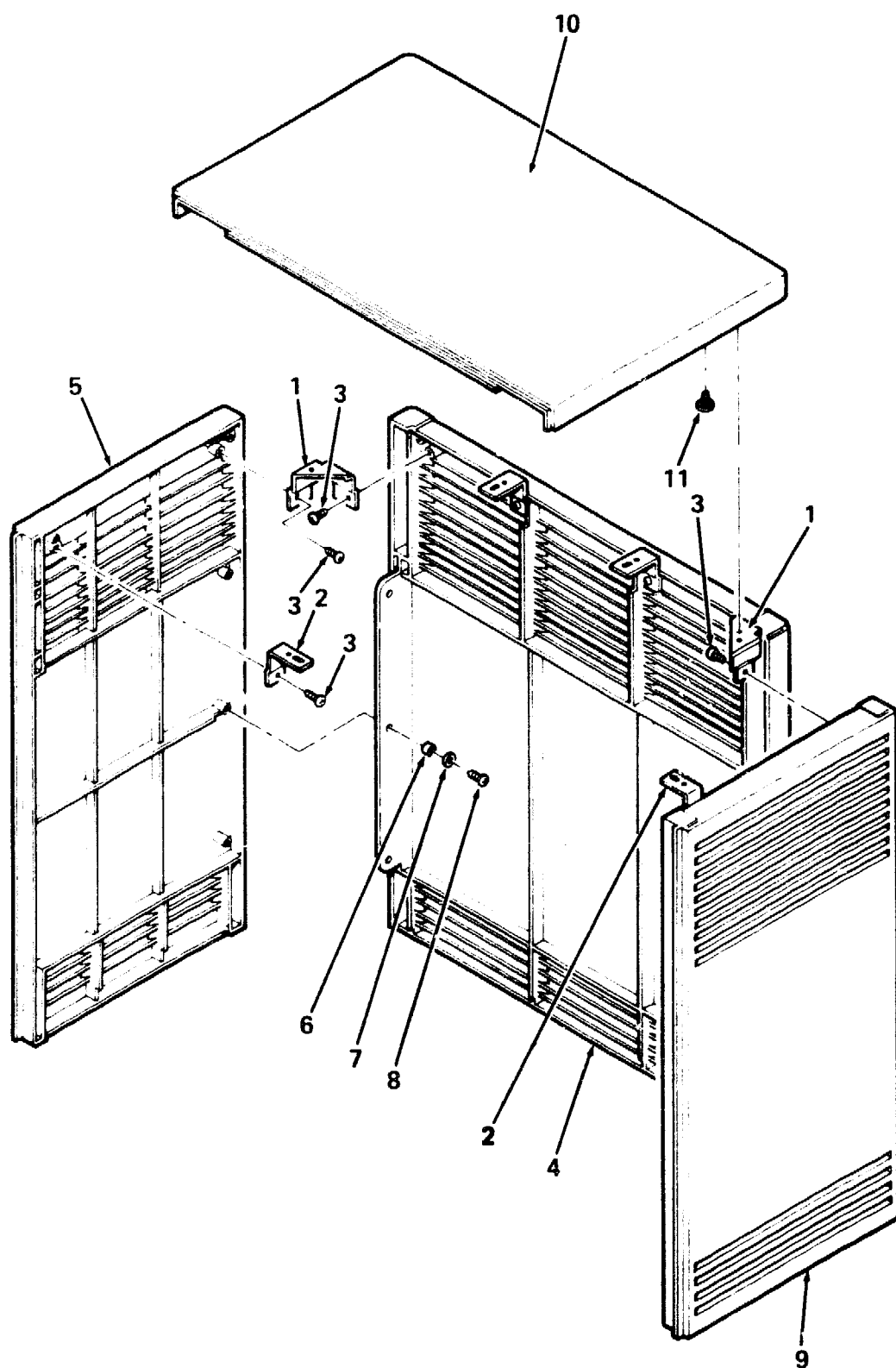

B213F-02-BD

**Figure 2. Enclosure Assembly, Shell**



FIG. & ITEM NO.	DESCRIPTION	DEC PART NO.	ECO CUT-IN 70-24037 00001	USED ON CODE	REF FIG NO.
2-	ENCLOSURE ASSEMBLY, SHELL	70-24037-01		CD	1
1	*Bracket, Corner	74-34126-01			
2	*Bracket, Side	74-34125-01			
3	*Screw, Self-Tap Phl Pan Hd No. 8-16 X 3/8	90-09800-04			
4	*Panel, Rear	74-33651-01			
5	*Panel, Left Side	74-33694-01			
6	*Sleeve	74-34424-01			
7	*Washer, Flat	90-06661-00			
8	*Screw, Self Tap Phl Hd No. 8-16 x 1/2	90-09800-08			
9	*Panel, Right Side	74-33647-01			
10	*Cover, Top	74-33646-01			
11	*Screw, Thread Rolling Shoulder	12-26868-01			

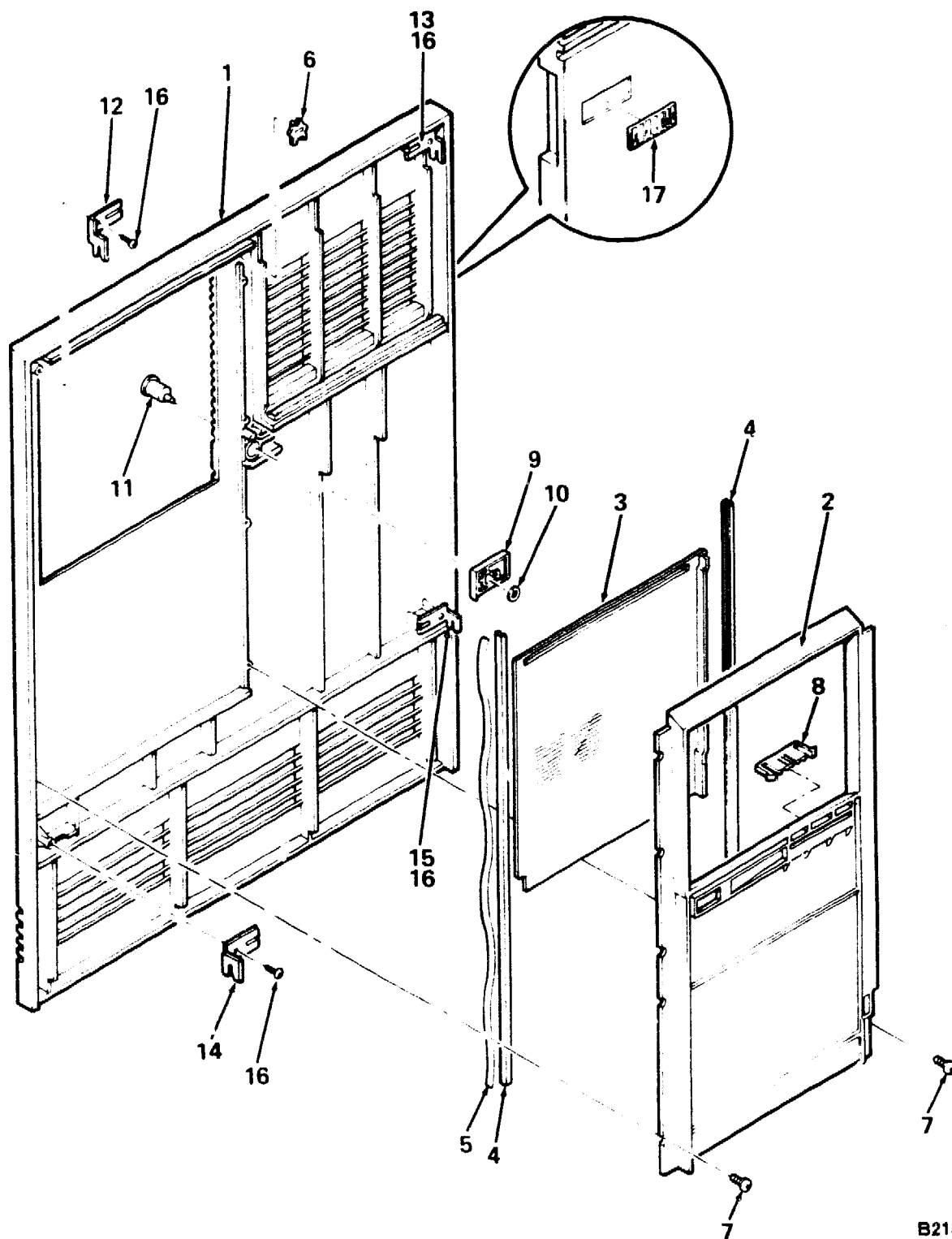

B213F-03-BD

**Figure 3. Panel Assembly, Front**

FIG. & ITEM NO.	DESCRIPTION	DEC PART NO.	ECO CUT-IN 70-24041 00000	USED ON CODE	REF FIG NO.
3-	PANEL ASSEMBLY, FRONT	70-24041-01		CD	1
1	*Panel, Front	74-33648-01			
2	*Bezel, Switch	74-34067-01			
3	*Door	74-34061-01			
4	*Channel, Front Panel	74-34062-01			
5	*Spring, Channel	74-34066-01			
6	*Stop, Door Position	74-34363-01			
7	*Screw, Self-Tap Phi Pan Hd No. 6-19 x 3/8	90-09800-06			
8	*Latch, Pull	74-34064-01			
9	*Latch, Slide	74-34065-01			
10	*Ring, Retainer	90-09257-05			
11	*Tumbler	74-34063-01			
12	*Bracket, Top Right Hand	74-34123-01			
13	*Bracket, Top Left Hand	74-34123-02			
14	*Bracket, Bottom Right Hand	74-34124-01			
15	*Bracket, Bottom Left Hand	74-34124-02			
16	*Screw, Self Tap Phi Pan Hd No. 8-16 X 3/8	90-09800-04			
17	*Logo	74-34426-01			

FIG. & ITEM NO.	DESCRIPTION	DEC PART NO.	ECO CUT-IN 70-24046 00001	USED ON CODE	REF FIG NO.
4-	BASE ASSEMBLY	70-24046-01		CD	1
1	*Base, Lower	74-33650-01			
2	*Wheel, Base	74-34068-01			
3	*Shaft, Wheel	74-34069-01			
4	*Pin, Roll	90-09385-00			
5	*Screw, Thread Rolling Shoulder	12-26868-01			
6	*Support, Label	74-34346-01			
7	*Screw, Self-Tap Phi Pan Hd No.6-19 x 3/8	90-09200-06			
8	*Fastener, Turn (See Note)	74-33854-01			
9	*Screw, Sems Phi Pan Hd No.10-32 x 5/16 (See Note)	90-09262-00			
Note : Item part of Figure 1. Shown here for clarity.					

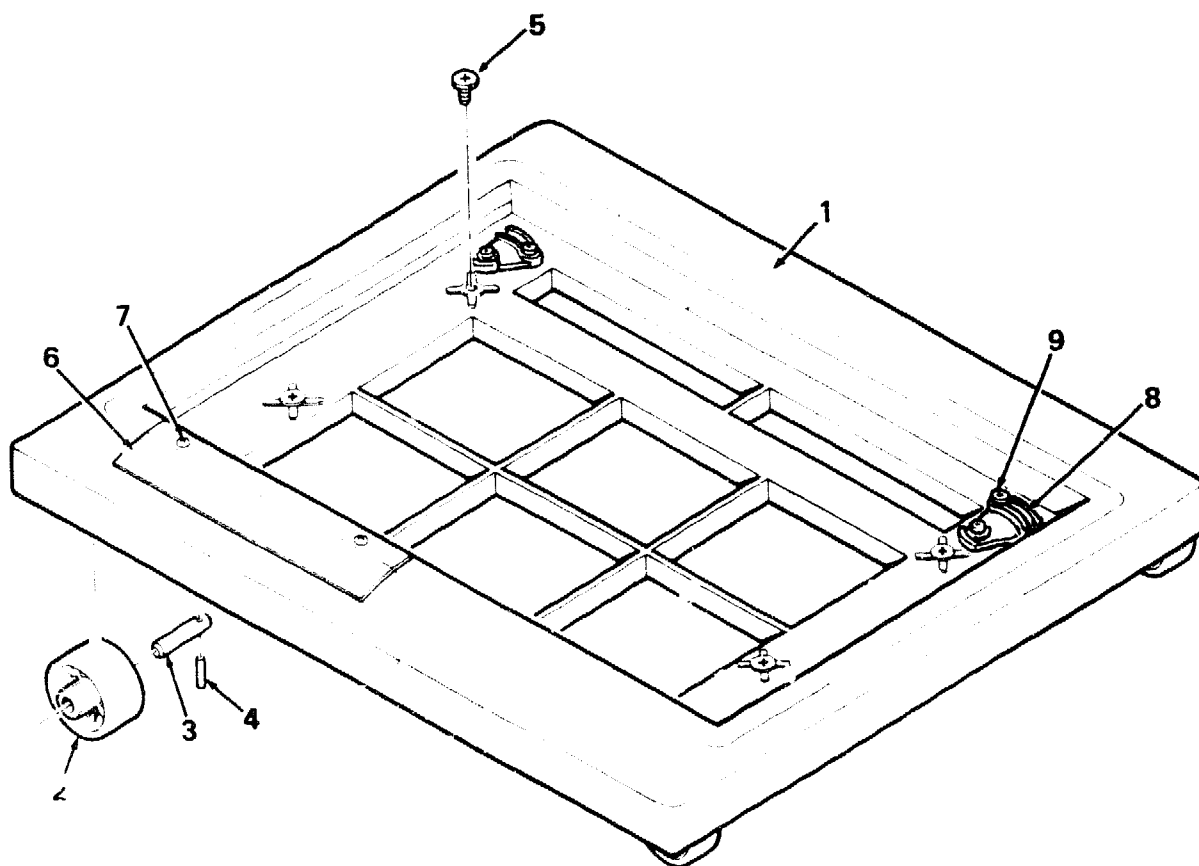

B213F-04-BD

Figure 4. Base Assembly

FIG. & ITEM NO.	DESCRIPTION	DEC PART NO.	ECO CUT-IN 70-25752 00001	USED ON CODE	REF FIG NO.
5-	OCP ASSEMBLY	70-25752-01			1
	1 *Bracket, Distribution (Weldment)	70-25736-02			
	2 *Module, DSSI BA200 Control	54-17388-01			
	3 *Screw, Self Tap Phi Hd No. 6-32 x 5/16 (Replaces 90-00049-22)	90-00063-13	00003		
	4 *Label, "Wiring Diagram BA215"	36-29233-01			
	5 *Washer, Retaining (Replaces 12-27764-01)	12-30421-01			
	6 *Screw, Shoulder No. 6-32 x 11/16	12-29665-01			
	7 *Label, "Do Not Expose"	36-20560-54			

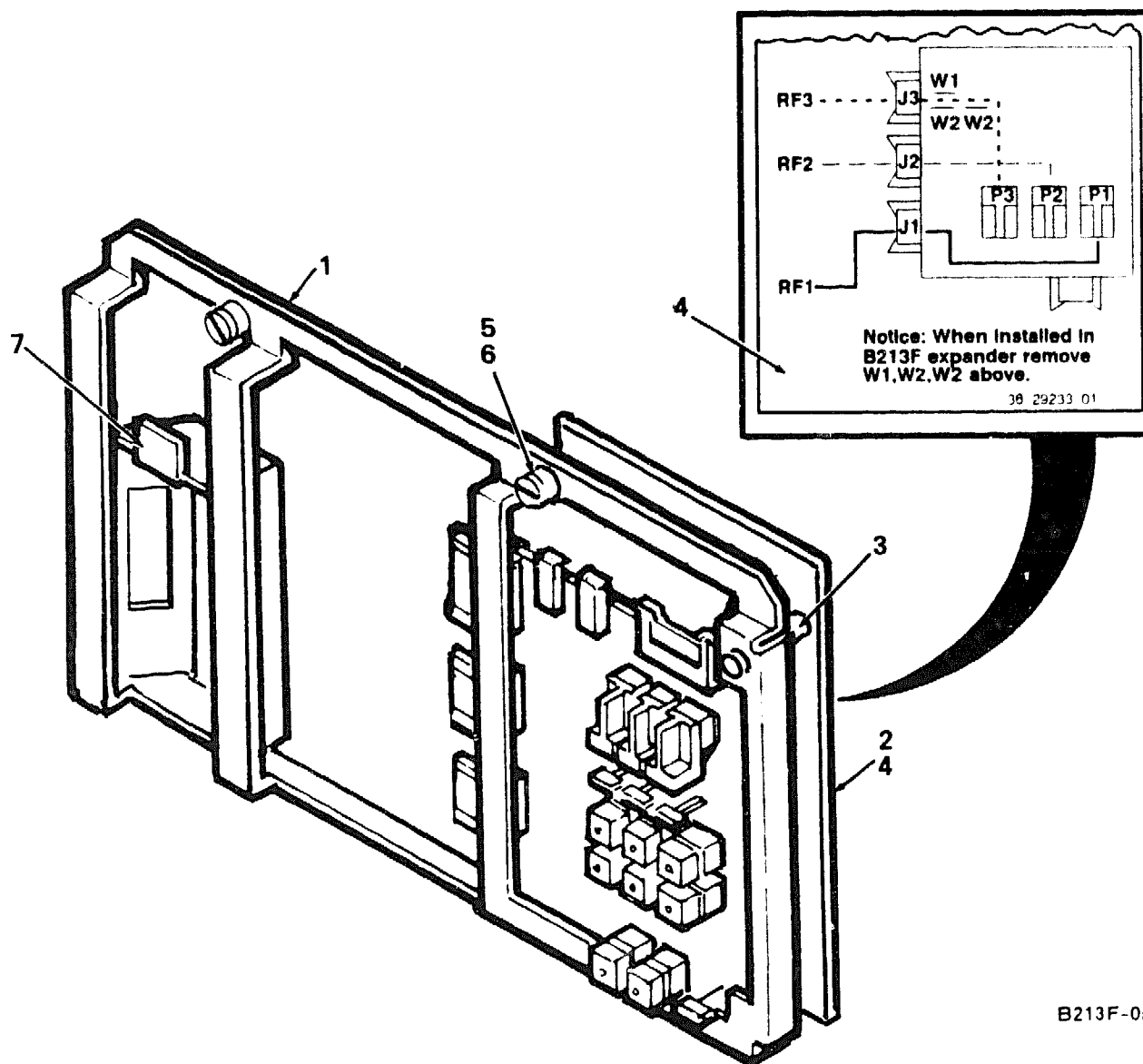

Figure 5. OCP Assembly

B213F-05-BD

# **EXPANDER TO HOST CABLE CONNECTIONS**



**THIS SECTION REFERS TO BA200 AND BA400 SERIES HOST SYSTEMS.  
THE FOLLOWING IS A REFERENCE LIST FOR THESE SYSTEMS.**

**BA200 SERIES HOST SYSTEMS:**

**DECsystem 5400  
MicroVAX 3300  
MicroVAX 3400  
MicroVAX 3500  
MicroVAX 3800**

**BA400 SERIES HOST SYSTEMS:**

**DECsystem 5500  
MicroVAX 4000-200  
MicroVAX 4000-300**

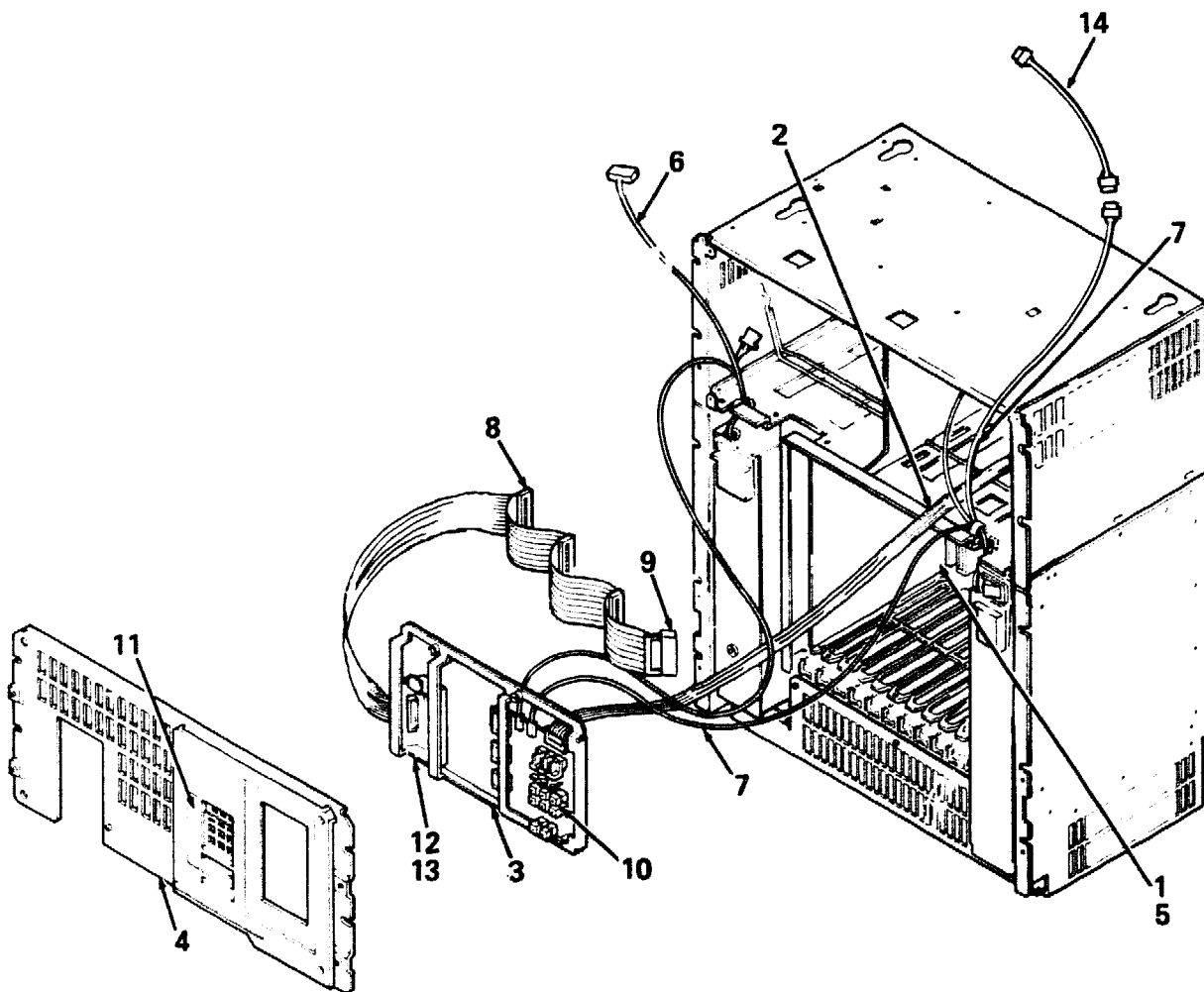

B213F-06-BD

**Figure 6. B213F Field Upgrade Internal DSSI Cabling**

FIG.& ITEM NO.	DESCRIPTION	DEC PART NO.	ECO CUT-IN	USED ON CODE	REF FIG NO.
6-	B213F FIELD UPGRADE INTERNAL DSSI CABLING				
1	*Module, +5/12 Load	M9060-YA			
2	*Cable Assembly, Flat Ribbon 10 Conductor	17-01964-01			
3	*OCP Assembly	70-25752-01			
4	*Panel Assembly, Front (DSSI)	70-25750-02			
5	*Label, "Module Number"	36-26883-17			
6	*Harness Assembly, Left Power	17-01989-01			
7	*Harness Assembly, Right Power	17-01990-01			
8	*Cable Assembly, Flat Ribbon, 50 Pin Daisy Chain	17-01836-01			
9	*Plug, Internal Terminator	12-28976-01			
10	*Lens, Encoder Set	12-28766-19			
11	*Label, "Control Panel"	36-30973-01			
12	*Plate Assembly, Connector	70-26206-01			
13	*Screw, Mach Flat Hd (Metric No. 02.5 x .08)	90-10917-01			
14	*Harness Assembly, 5 Pin to 4 Pin Adaptor	17-01937-01			

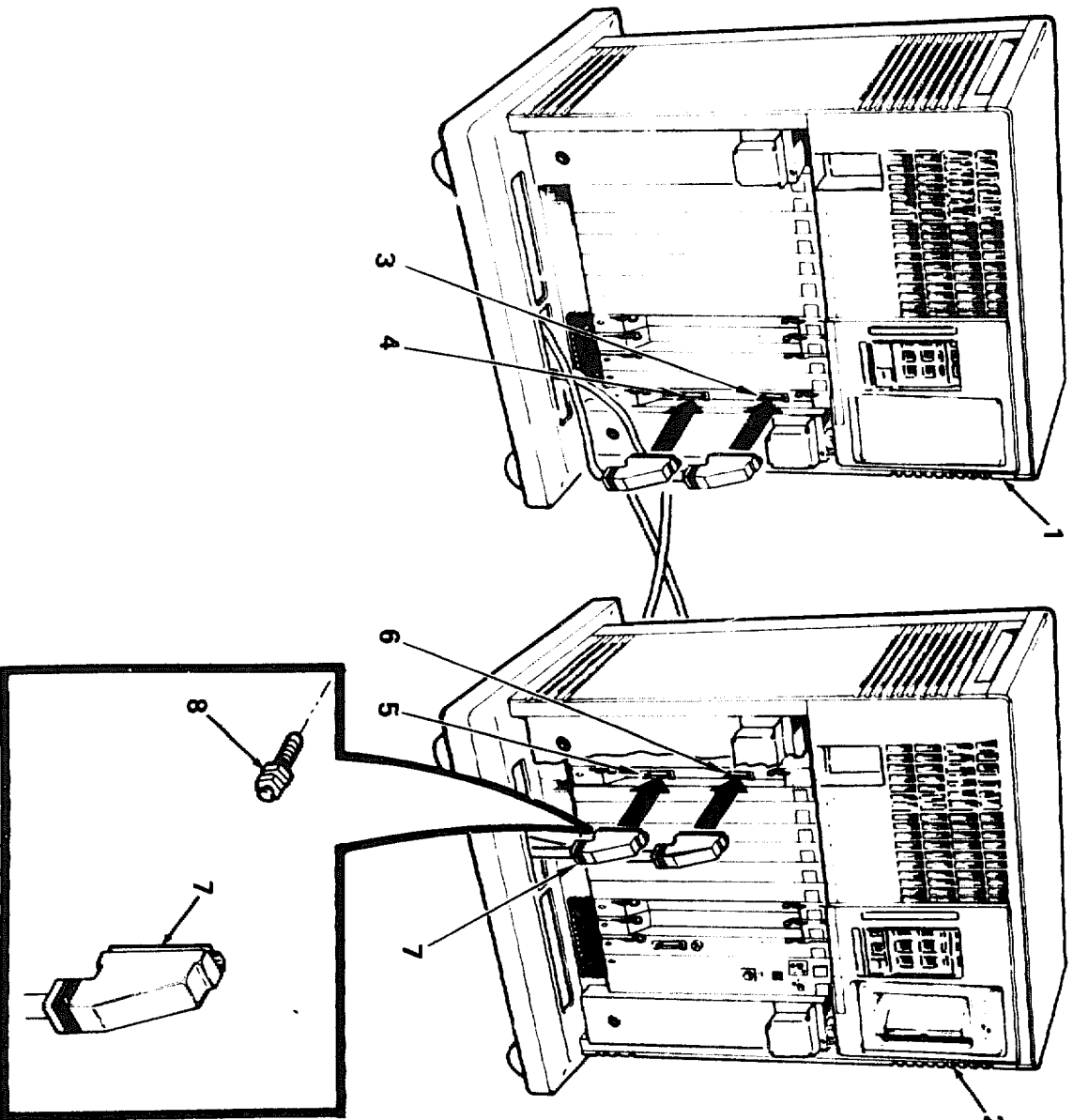

B213F-07-BD

Figure 7. B213F to BA200/400 Host System w/Q-Bus Cables

PARTS LIST

FIG. & ITEM NO.	DESCRIPTION	DEC PART NO.	ECO CUT-IN	USED ON CODE	REF FIG NO.
7-	B213F TO BA200/400 HOST SYSTEM w/Q-BUS CABLES				
1	*B213F Expander	B213F			
2	*BA200/400 Host System	MVXXXX			
3	*Module, Expander (J1 Conn)	M9405-PA			
4	*Module, Expander (J2 Conn)	M9405-PA			
5	*Module, Expander (J1 Conn)	M9404-PA			
6	*Module, Expander (J2 Conn)	M9404-PA			
7	*Cable Assembly, Q-Bus	BC04V-09			
8	*Post Assembly, Locking	12-18672-00			

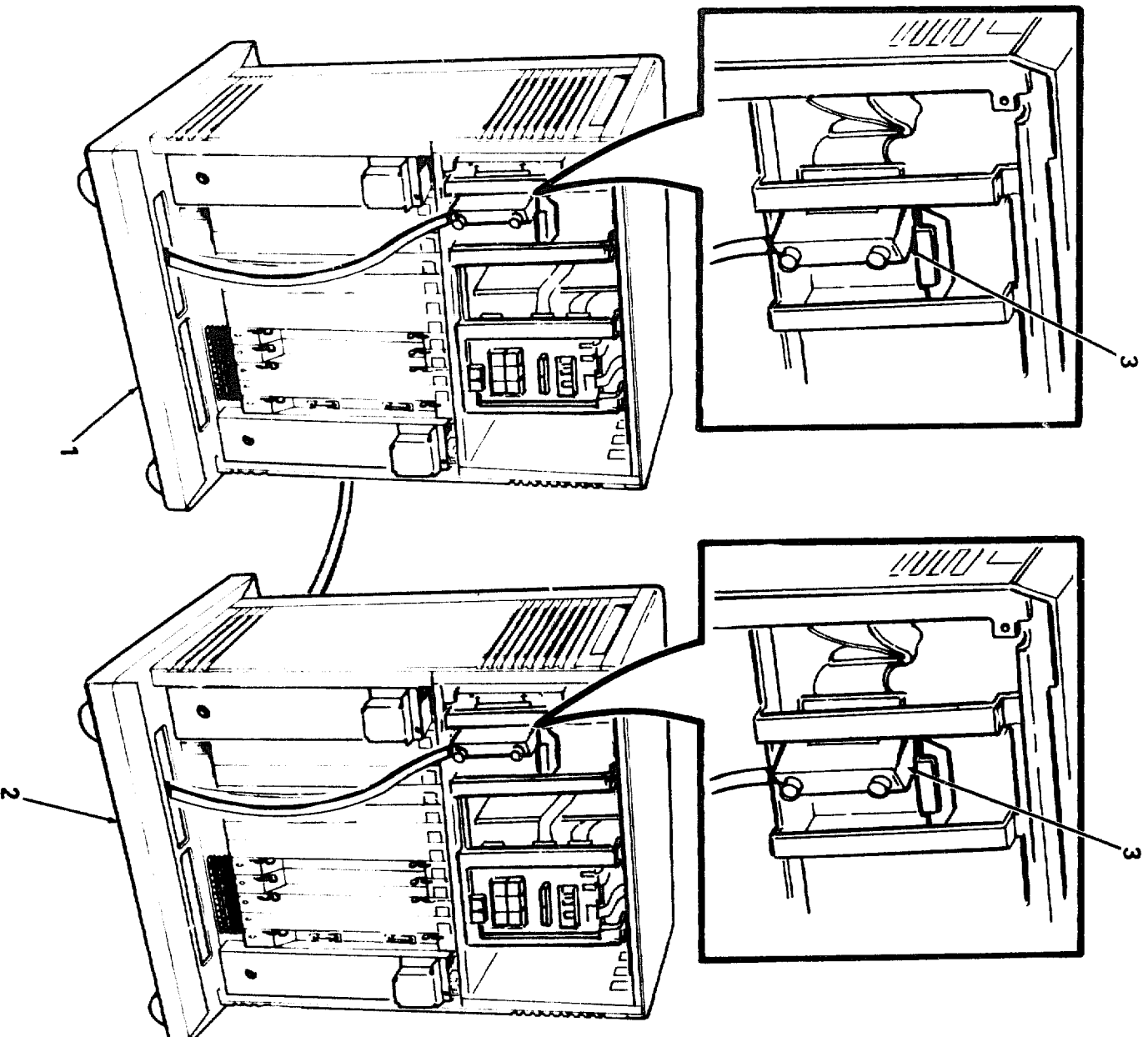

Figure 8. B213F to BA200 Host System w/DSSI Cables

B213F-08-BD

PARTS LIST

- 17 -

IPB-B213F

FIG. & ITEM NO.	DESCRIPTION	DEC PART NO.	ECO CUT-IN	USED ON CODE	REF FIG NO.
8-	B213F TO BA200 HOST SYSYTEM w/DSSI CABLES				
1	*B213F Expander	B213F			
2	*BA200 Host System	MVXXXX			
3	*Cable, Assembly DSSI (BC21M-09)	17-02152-03			

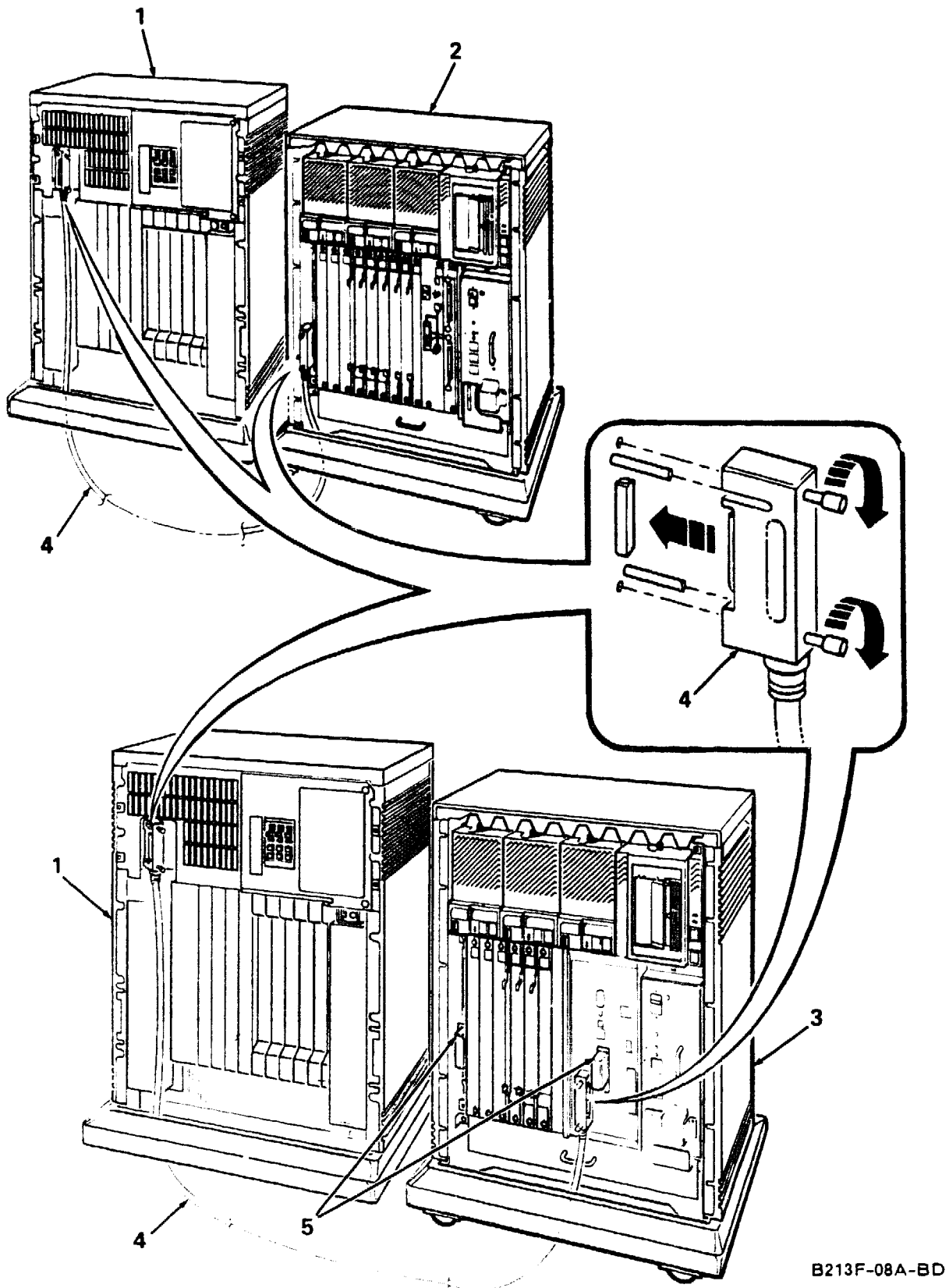
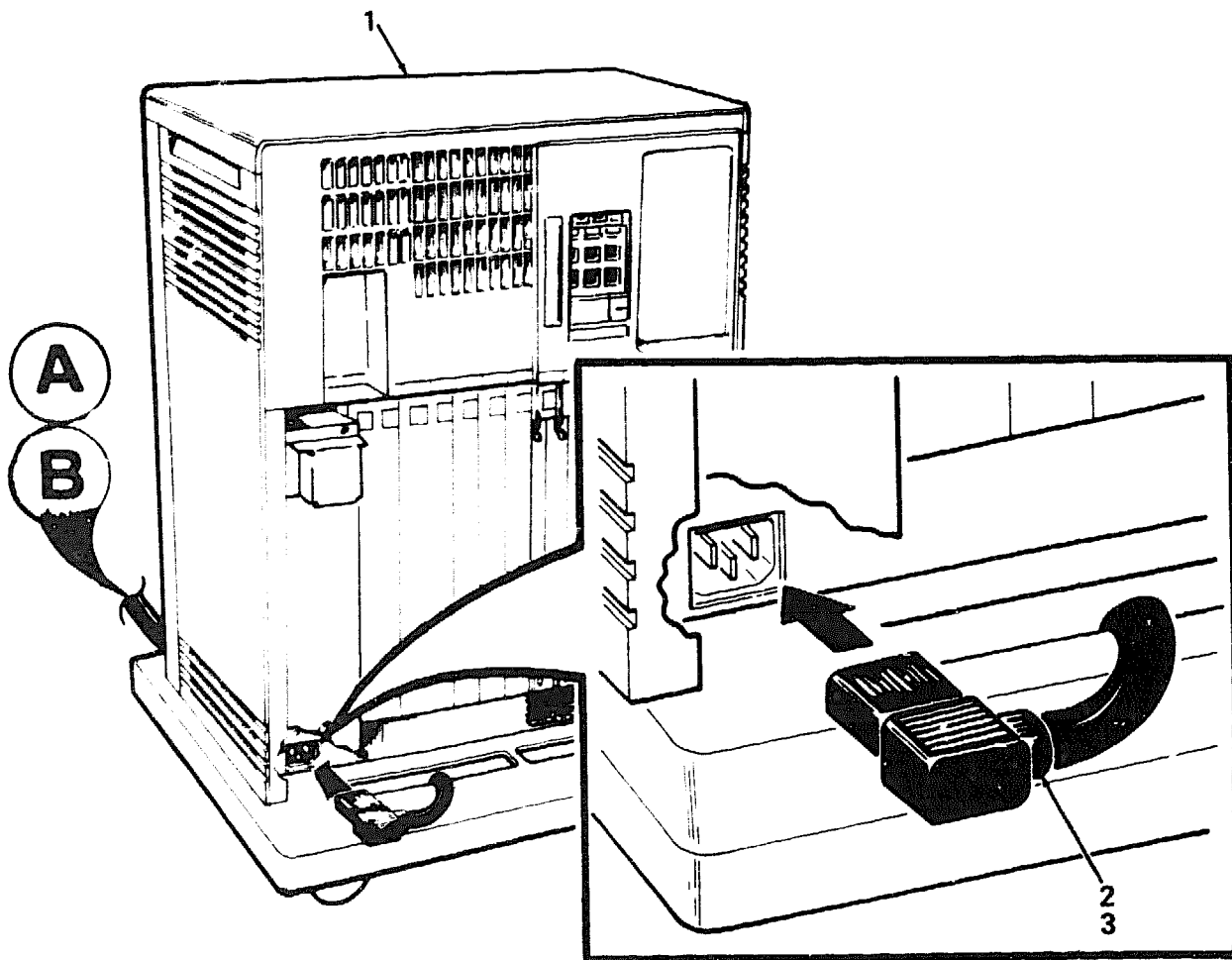

Figure 8A. B213F to BA400 Host System w/DSSI Cables

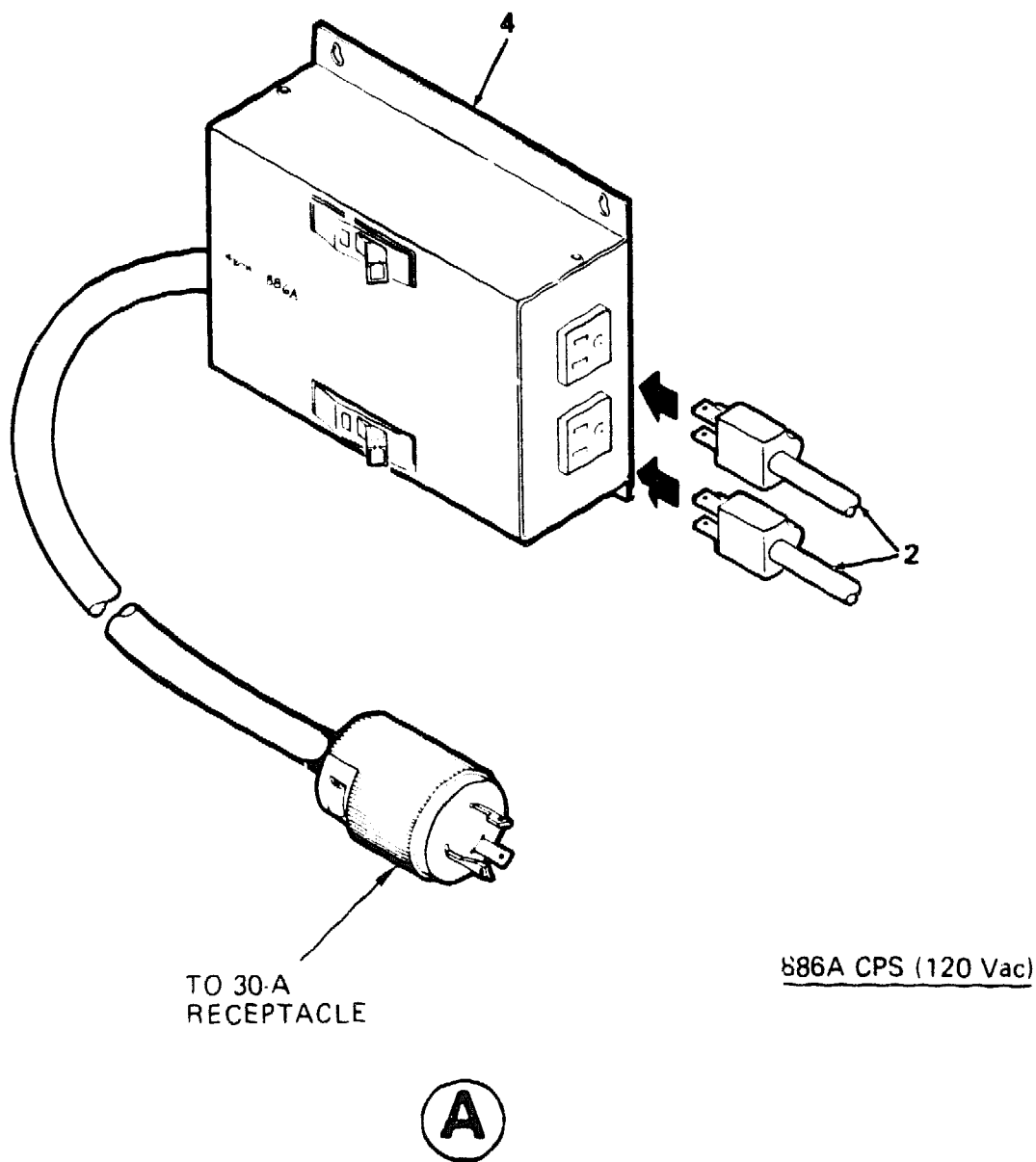

FIG. & ITEM NO.	DESCRIPTION	DEC PART NO.	ECO CUT-IN	USED ON CODE	REF FIG NO.
8A-	B213F TO BA400 HOST SYSYTEM w/DSSI CABLES				
1	*B213F Expander	B213F			
2	*BA430 Host System	MVXXXX			
3	*BA440 Host System	MVXXXX			
4	*Cable, Assembly DSSI (BC21M-09)	17-02152-03			
5	*Terminator, External	12-29258-01			



B213F-09-BD

**Figure 9. Power Connections, BA200 Host System AC (Sheet 1 of 3)**



B213F-09A-BD

**Figure 9. Power Connections, BA200 Host System AC (Sheet 2 of 3)**

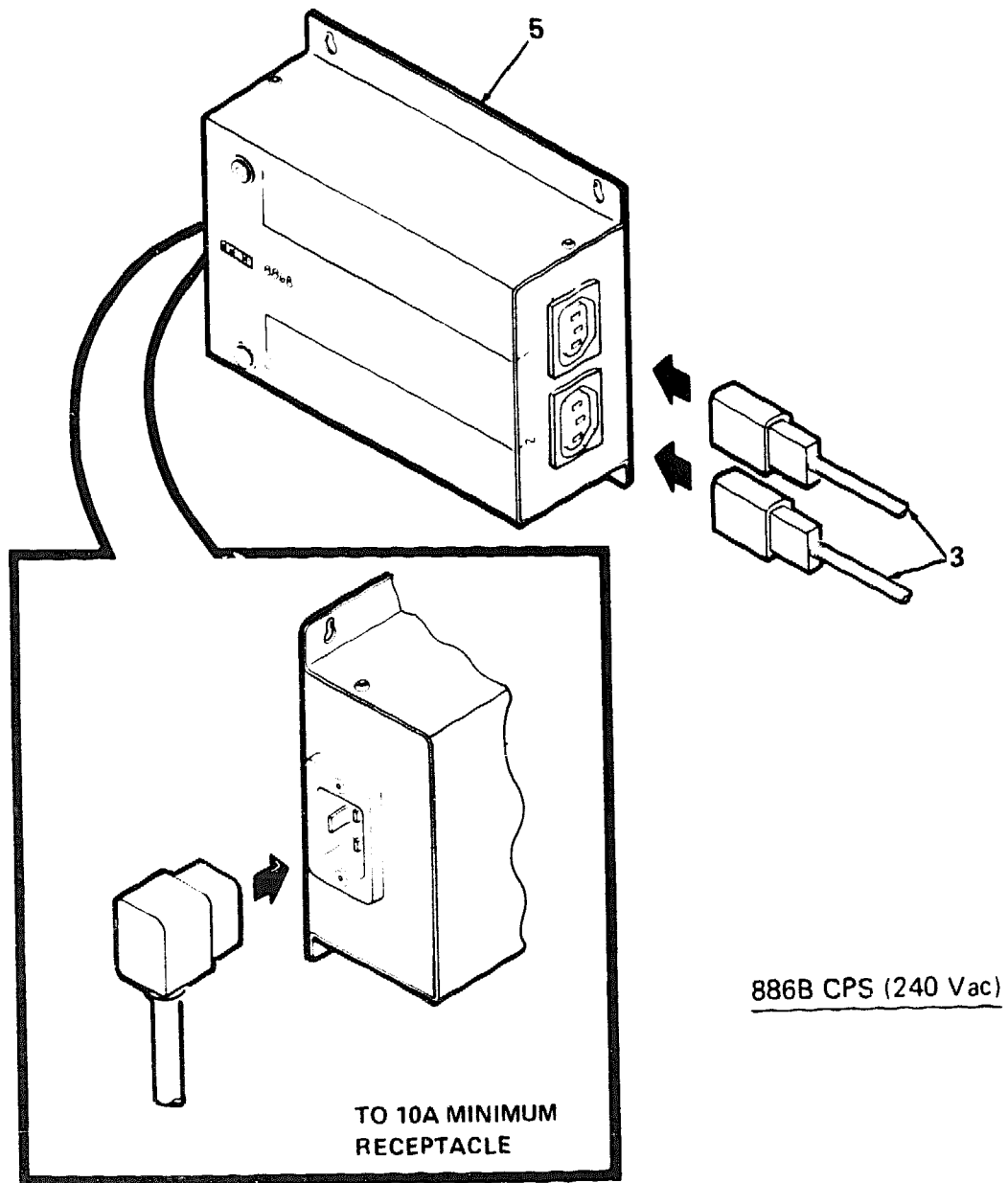

**B**

B213F-09B-BD

**Figure 9. Power Connections, BA200 Host System AC (Sheet 3 of 3)**

FIG.& ITEM NO.	DESCRIPTION	DEC PART NO.	ECO CUT-IN	USED ON CODE	REF FIG NO.
9-	POWER CONNECTIONS, BA200 HOST SYSTEM AC				
1	*B213F Expander	B213F			
2	*Cord, Power (120V) (BN20A-2E)	17-00083-43		AC	
3	*Cord, Power (240V)	17-00365-06		BD	
4	*Switch Assembly, Controlled Power (120V) (886-A)	30-30166-01		AC	
5	*SWITCH ASSEMBLY, CONTROLLED POWER (240V) (886-B)	30-30166-02		BD	
	**Cord, Power (UK/Ireland) (240V) (BN18B-4E)	17-00209-05		BD	
	**Cord, Power (Austria, Belgium, France Finland, Germany, Netherlands, Norway, Portugal, Spain, Sweden, Switzerland) (240V) (BN18C-4E)	17-00199-10		BD	
	**Cord, Power (Australia/New Zealand) (240V) (BN18D-4E)	17-00198-05		BD	
	**Cord, Power (Italy/Switzerland) (240V) (BN18E-4E)	17-00364-06		BD	
	**Cord, Power (Israel) (240V) (BN18F-4E)	17-00457-06		BD	
	**Cord, Power (India) (240V) (BN18H-4E)	17-00456-06		BD	
	**Cord, Power (Denmark) (240V) (BN18P-4E)	17-01255-01		BD	
	**Cord, Power (US/Japan) (240V) (BN18T-4E)	17-00083-37		BD	

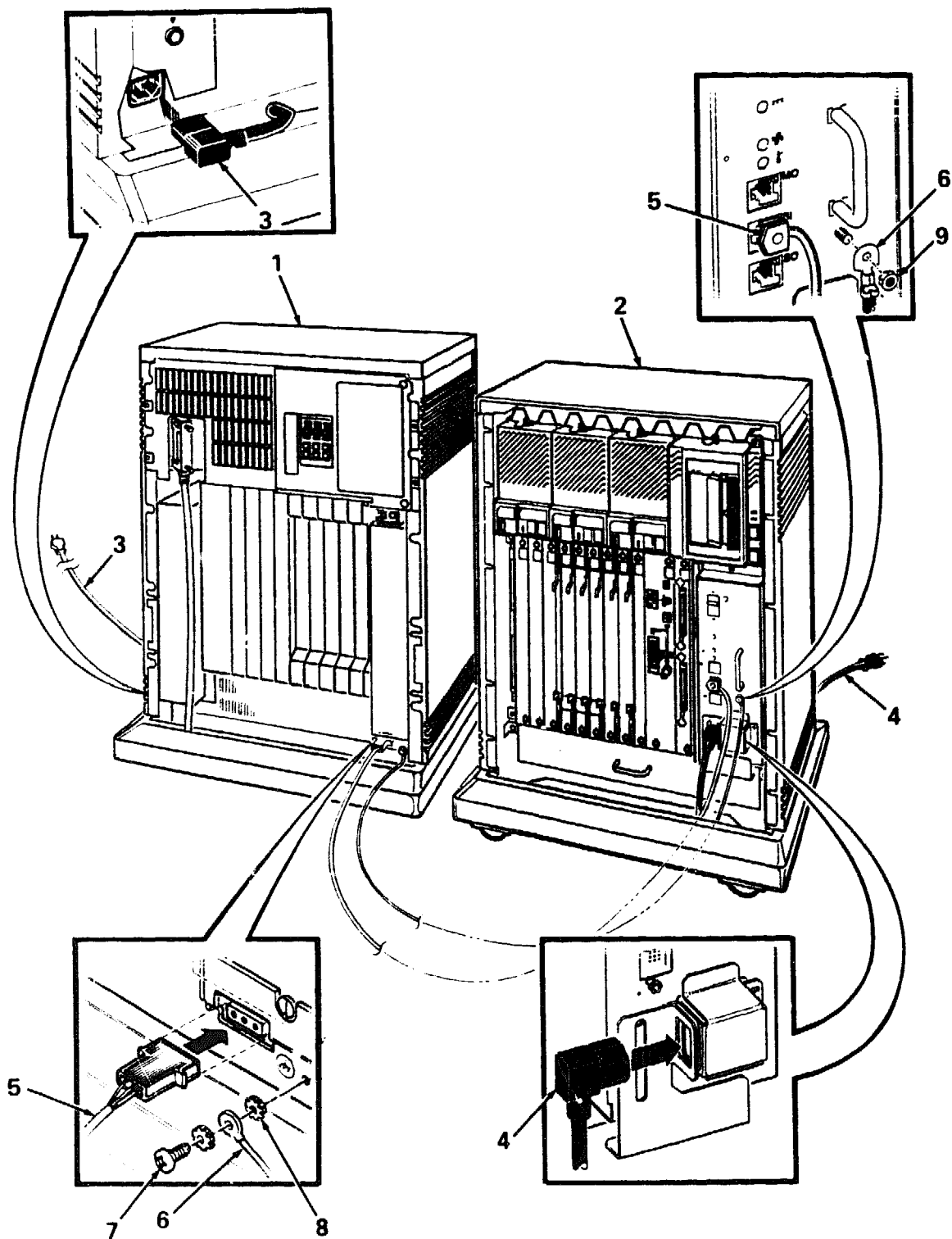

B213F-09C-BD

**Figure 9A. Power Connections/Power Control Bus Connections,  
B213F to BA400 Host System**

PARTS LIST

FIG. & ITEM NO.	DESCRIPTION	DEC PART NO.	ECO CUT-IN	USED ON CODE	REF FIG NO.
9A-	POWER CONNECTIONS/POWER CONTROL BUS CONNECTIONS, B213F TO BA400 HOST SYSTEM				
1	*B213F Expander	B213F			
2	*BA400 Host System	MVXXXX			
3	*Cord, Power (US) (120V) (BN20A-2E)	17-00083-43		AC	
4	*Cord, Power (Japan) (240V) (BN20B-2E)	17-00083-44		BD	
	*Cord, Power (Australia/New Zealand) (240V) (BN20C-2E)	17-00198-04		BD	
	*Cord, Power (Austria, Belgium, (BN20D-2E) Czechoslovakia, France, Finland, Germany, Hungary, Netherlands, Norway, Poland, Portugal, Spain, Sweden, Switzerland) (240V)	17-00199-07		BD	
	*Cord, Power (UK/Ireland) (240V) (BN20E-2E)	17-00209-04		BD	
	*Cord, Power (Switzerland) (240V) (BN20F-2E)	17-00210-04		BD	
	*Cord, Power (Denmark) (240V) (BN20H-2E)	17-00310-07		BD	
	*Cord, Power (India/South Africa) (240V) (BN20K-2E)	17-00456-05		BD	
	*Cord, Power (Israel) (240V) (BN20L-2E)	17-00457-05		BD	
	*Cord, Power (Italy) (240V) (BN20J-2E)	17-00364-05		BD	
	*KIT, SEQUENCING AND GROUNDING	H4010-AA			
5	**Cable Assembly, Power Sequence	17-02637-01			
6	**Cable Assembly, Ground	12-13756-A8			
7	**Screw, Phi Truss Hd No. 6-32 x 1/2	90-06024-03			
8	**Washer, Self Lock	90-07649-00			
9	**Nut, Kep 10-32	90-06565-00			
10	**Expansion Installation Supplement (Not Shown)	EK-431AA-IN			
11	**Label, "Ground" (Not Shown)	36-12680-04			

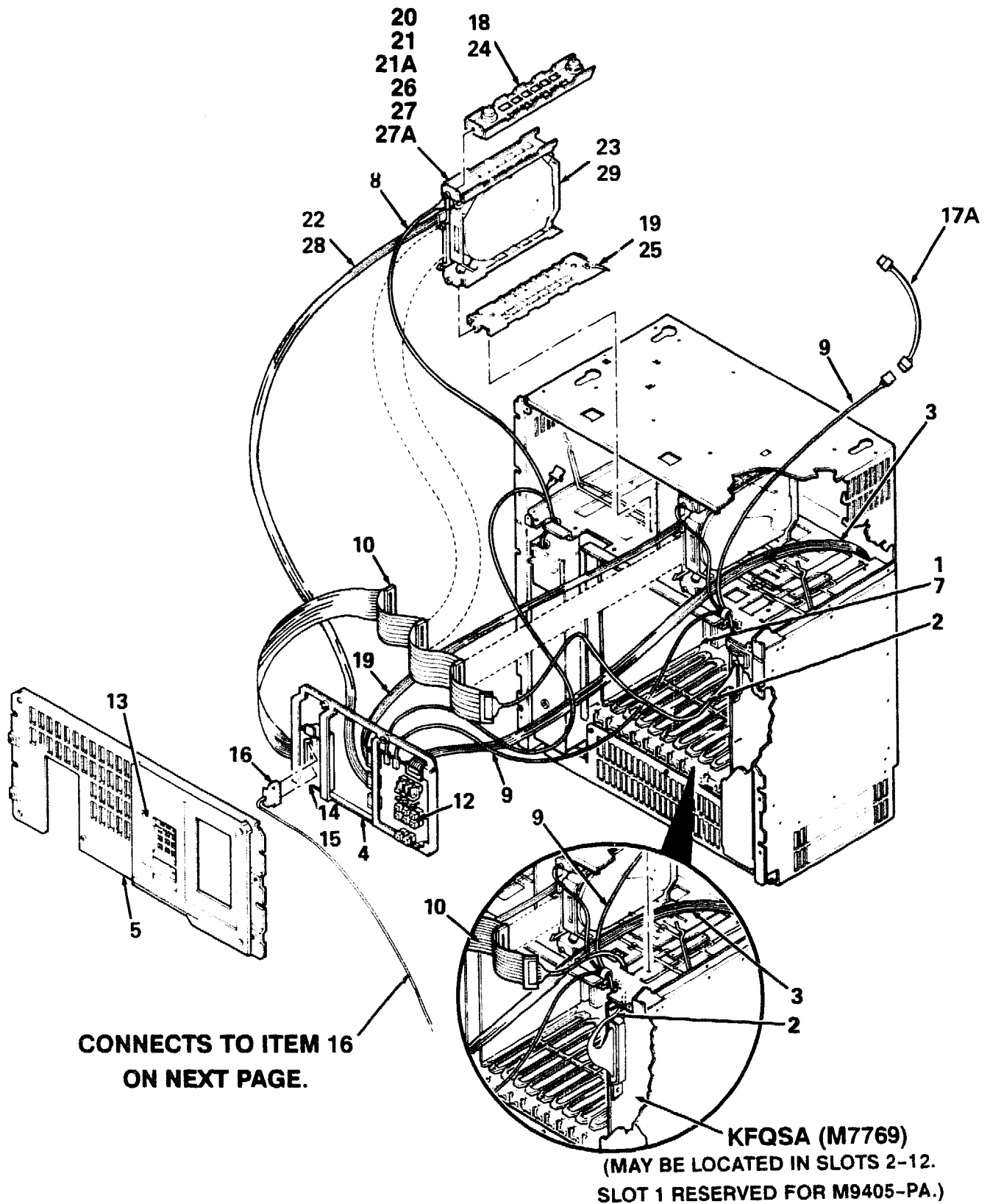

## B213F EXPANDER

B213F-10-BD

Figure 10. DSSI Configuration, B213F To BA200 Host System Expanded (Sheet 1 of 2)

PARTS LIST



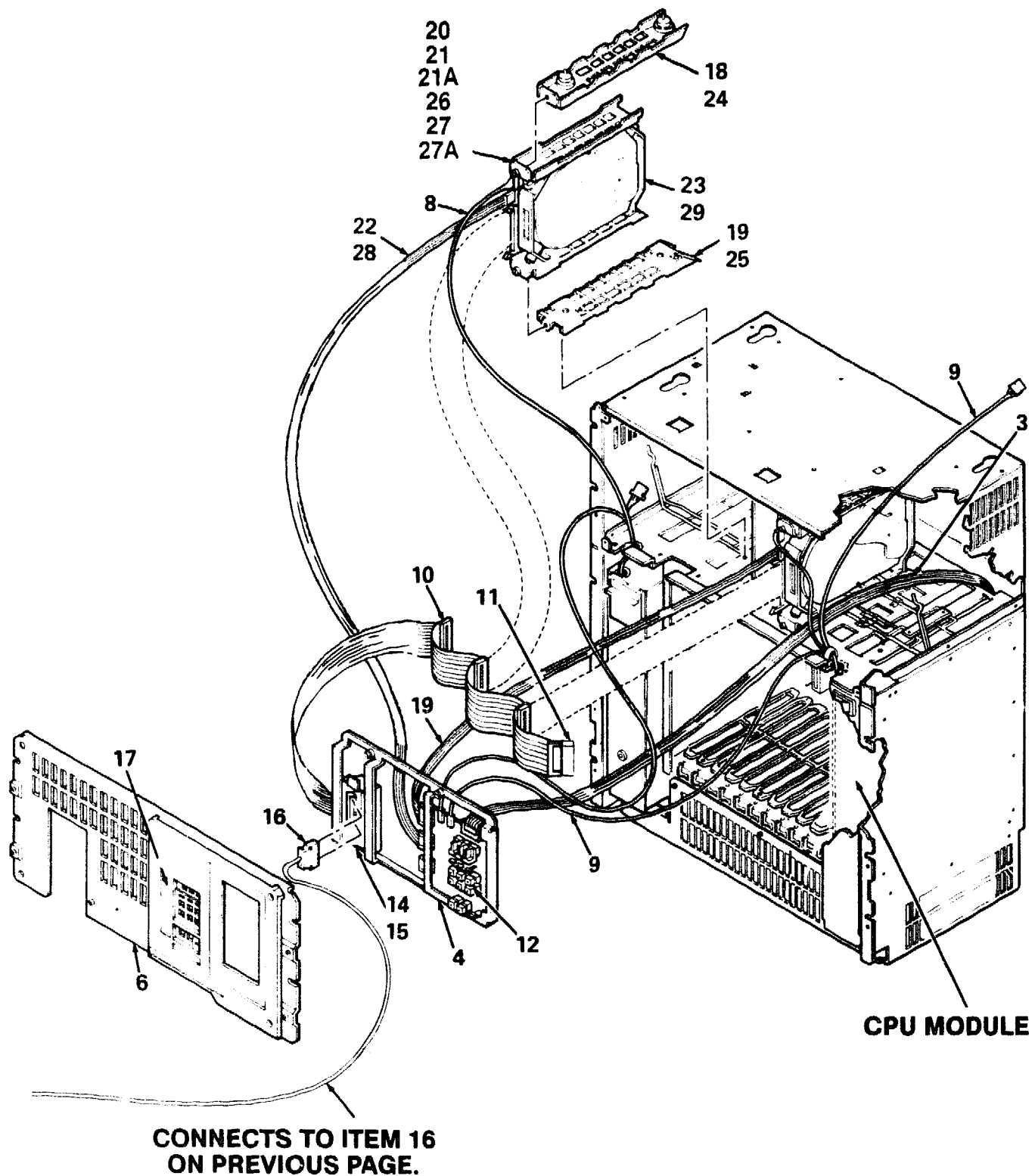

## BA200 HOST SYSTEM

B213F-10A-BD

Figure 10. DSSI Configuration, B213F To BA200 Host System Expanded (Sheet 2 of 2)

FIG.& ITEM NO.	DESCRIPTION	DEC PART NO.	ECO CUT-IN	USED ON CODE	REF FIG NO.
10-	DSSI CONFIGURATION, B213F TO BA200 HOST SYSTEM EXPANDED				
1	*Module, +5/12 Load	M9060-YA			
2	*Cable Assembly, Round, 50 Conductor	17-01931-01			
3	*Cable Assembly, Flat Ribbon, 10 Conductor	17-01964-01			
4	*OCP Assembly	70-25752-01			
5	*Panel Assembly, Front (DSSI)	70-25750-02			
6	*Panel Assembly, Front (DSSI)	70-25750-01			
7	*Label, "Module Number"	36-26883-17			
8	*Harness Assembly, Left Power	17-01989-01			
9	*Harness Assembly, Right Power	17-01990-01			
10	*Cable Assembly, Flat Ribbon, 50 Pin Daisy Chain	17-01836-01			
11	*Plug, Internal Terminator	12-28976-01			
12	*Lens, Encoder Set	12-28766-19			
13	*Label, "Control Panel"	36-30973-01			
14	*Plate Assembly, Connector	70-26206-01			
15	*Screw, Mach Flat Hd (Metric No. 02.5 x .08)	90-10917-01			
16	*Cable Assembly (BC21M-09)	17-01252-03			
17	*Label "Control Panel"	36-29341-01			
17A	*Harness Assembly, 5 Pin to 4 Pin Adaptor	17-01937-01			
	*****	*****			
10A	*KIT, RF30 DISK DRIVE MOUNTING w/CABLES	RF30E-SA			
18	**Shock Assembly, Top	70-25452-02			
19	**Shock Assembly, Bottom	70-25452-01			
20	**Bracket, Bottom and Top Drive	74-36498-01			
21	***Screw, Slotted Shoulder Hd No. 6-32 x 1/2	12-27771-01			
21A	**Screw, Mach Flat Hd No. 6-32 x 5/32	90-00039-28			
22	**Cable Assembly, Flat Ribbon, 10 Conductor	17-01936-01			
23	**DISK DRIVE, HALF HEIGHT w/o SKID PLATE	RF30-EA			
	***Module, Drive	54-18247-01			
	***Mechanics, Drive	70-23536-01			
	*****	*****			
10B-	*KIT, RF71 DISK DRIVE MOUNTING w/CABLE	RF71E-SA			
24	**Shock Assembly, Top	70-25452-04			
25	**Shock Assembly, Bottom	70-25452-03			
26	**Bracket, Bottom and Top Drive	74-36490-01			
27	***Screw, Slotted Shoulder Hd No. 6-32 x 1/2	12-27771-01			
27A	**Screw, Mach Flat Hd No. 6-32 x 5/32	90-00039-28			
28	**Cable Assembly, Flat Ribbon, 10 Conductor	17-01936-01			
29	**DISK DRIVE, w/o SKID PLATE	RF71-EA			
	***Module, Drive	54-18316-02			
	***Mechanics, Drive	70-23537-01			

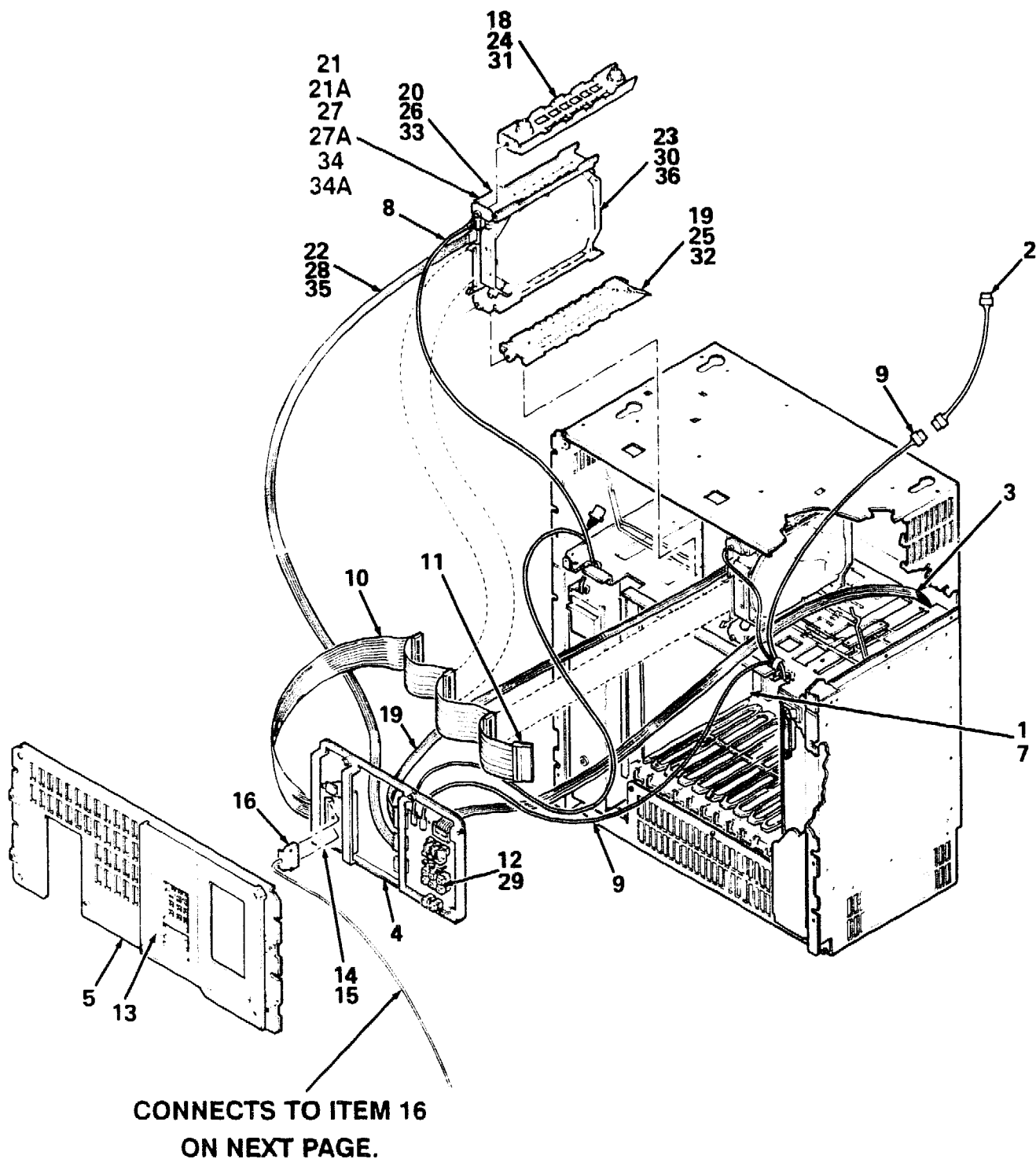

## B213F EXPANDER

B213F-10B-BD

Figure 10C. DSSI Configuration, B213F To BA400 Host System Expanded (Sheet 1 of 2)

PARTS LIST

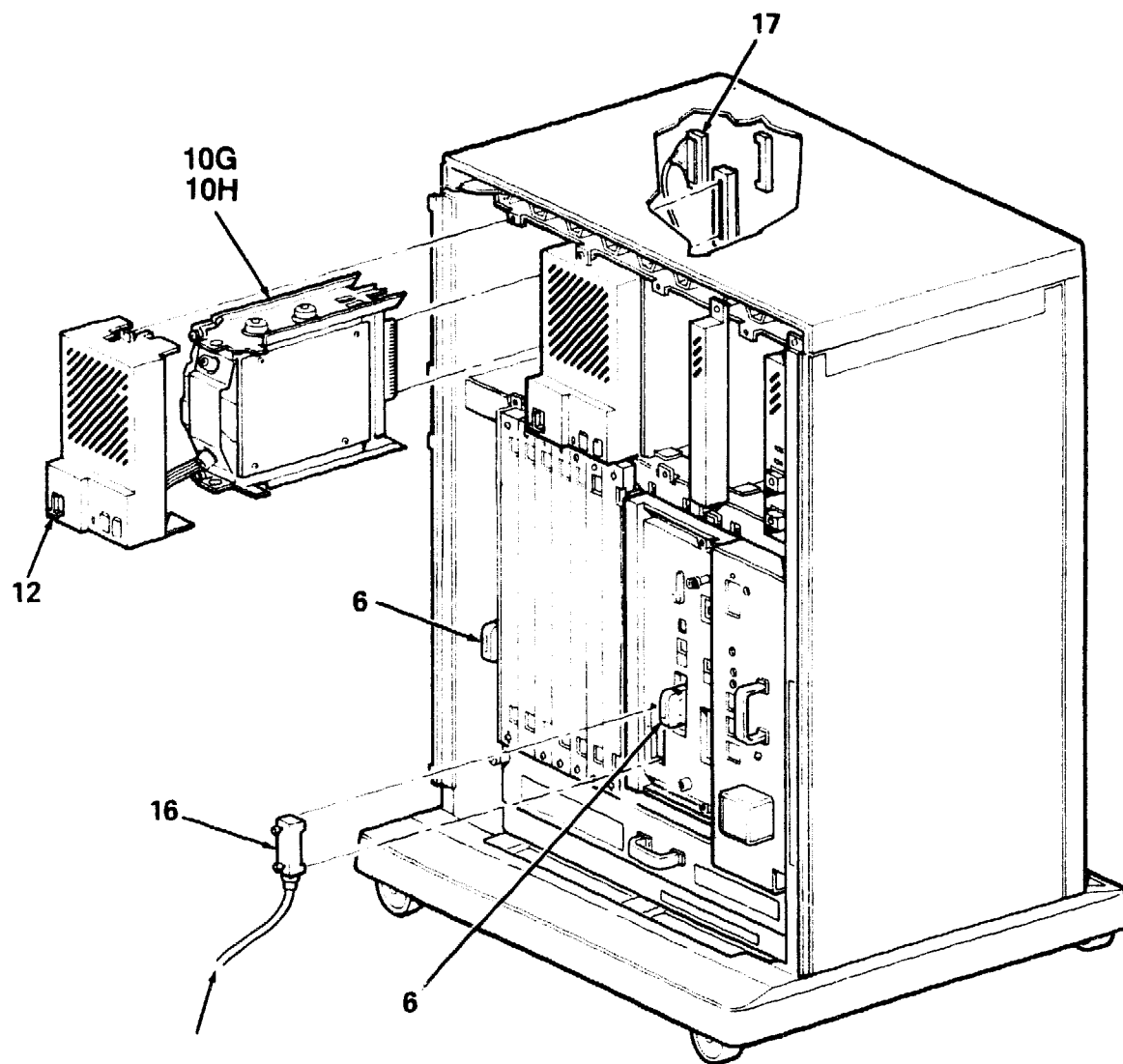

**CONNECTS TO ITEM 16  
ON PREVIOUS PAGE.**

## BA400 HOST SYSTEM

B213F-10C-BD

**Figure 10C. DSSI Configuration, B213F To BA400 Host System Expanded (Sheet 2 of 2)**

FIG.& ITEM NO.	DESCRIPTION	DEC PART NO.	ECO CUT-IN	USED ON CODE	REF FIG NO.
10C-	DSSI CONFIGURATION, B213F TO BA400 HOST SYSTEM EXPANDED				
1	*Module, +5/12 Load	M9060-YA			
2	*Harness Assembly, 5 Pin to 4 Pin Adapter	17-01937-01			
3	*Cable Assembly, Flat Ribbon, 10 Conductor	17-01964-01			
4	*OCP Assembly	70-25752-01			
5	*Panel Assembly, Front (DSSI)	70-25750-02			
6	*Terminator, External	12-29258-01			
7	*Label, "Module Number"	36-26883-17			
8	*Harness Assembly, Left Power	17-01989-01			
9	*Harness Assembly, Right Power	17-01990-01			
10	*Cable Assembly, Ribbon, 50 Pin Daisy Chain	17-01836-01			
11	*Terminator, Internal	12-28976-01			
12	*Lens, Encoder Set	12-28766-19			
13	*Label, "Control Panel"	36-30973-01			
14	*Plate Assembly, Connector	70-26206-01			
15	*Screw, Mach Flat Hd (Metric No. 02.5 x .08)	90-10917-01			
16	*Cable Assembly, DSSI External (BC21M-09)	17-01252-03			
17	*Cable Assembly, DSSI Internal	70-27458-01			
.....					
10D	*KIT, RF30 DISK DRIVE MOUNTING w/CABLES (INSTALLED IN BA200 SERIES ONLY)	RF30E-SA			
18	**Shock Assembly, Top	70-25452-02			
19	**Shock Assembly, Bottom	70-25452-01			
20	**Bracket, Bottom and Top Drive	74-36498-01			
21	***Screw, Slotted Shoulder Hd No. 6-32 x 1/2	12-27771-01			
21A	***Screw, Mach Flat Hd No. 6-32 x 5/32	90-00039-26			
22	**Cable Assembly, Ribbon, 10 Conductor	17-01936-01			
23	**DISK DRIVE, HALF HEIGHT w/o SKID PLATE	RF30-EA			
	***Module, Drive	54-18247-01			
	***Mechanics, Drive	70-23536-01			

FIG.& ITEM NO.	DESCRIPTION	DEC PART NO.	ECO CUT-IN	USED ON CODE	REF FIG NO.
10E-	*KIT, RF31 DISK DRIVE MOUNTING w/CABLES (INSTALLED IN BA200 SERIES ONLY)	RF31E-SA			
24	**Shock Assembly, Top	70-25452-02			
25	**Shock Assembly, Bottom	70-25452-01			
26	**Bracket, Bottom and Top Drive	74-36498-01			
27	***Screw, Slotted Shoulder Hd No. 6-32 x 1/2	12-27771-01			
27A	***Screw, Machine Flat Hd No. 6-32 x 5/32	90-00039-28			
28	**Cable Assembly, Ribbon, 10 Conductor	17-01936-01			
29	**Lens, Encoder Set	12-28766-19			
30	**DISK DRIVE, 381 MB	RF31-EA			
	***Module, Drive	54-18247-01			
	***Mechanics, Drive	70-23536-01			
*****					
10F	*KIT, RF71 DISK DRIVE MOUNTING w/CABLES (INSTALLED IN BA200 SERIES ONLY)	RF71E-SA			
31	**Shock Assembly, Top	70-25452-04			
32	**Shock Assembly, Bottom	70-25452-03			
33	**Bracket, Bottom and Top Drive	74-36498-01			
34	***Screw, Slotted Shoulder Hd No. 6-32 x 1/2	12-27771-01			
34A	***Screw, Machine Flat Hd No. 6-32 x 5/32	90-00039-28			
35	**Cable Assembly, Ribbon, 10 Conductor	17-01936-01			
36	**DISK DRIVE, w/o SKID PLATE	RF71-EA			
	***Module, Drive	54-18316-02			
	***Mechanics, Drive	70-23537-01			
*****					
10G-	*STORAGE ELEMENT, RF31E (INSTALLED IN BA400 SERIES ONLY)	RF31E-AA			
	**Mounting Assembly, RF31 ISE	70-28086-01			
	**Bezel, Disk Drive	70-27049-04			
	**Label, "Switch Marker"	36-18490-02			
	**Label, "Bar Code"	36-33151-03			
	**Label, "Drive Controller"	36-33183-01			
	**Label, "Drive No. 2 LV"	36-33183-02			
	**Label, "Bus ID"	36-33183-03			
	**Label, "No. 2 LV"	36-33183-04			
*****					
10H-	*STORAGE ELEMENT, RF71E (INSTALLED IN BA400 SERIES ONLY)	RF71E-AA			
	**Mounting Assembly, RF71 ISE	70-28087-01			
	**Bezel, Disk Drive	70-27049-04			
	**Label, Switch Marker	36-18490-02			
	**Label, Bar Code	36-33151-03			
	**Label, "Drive Controller"	36-33183-01			
	**Label, "Drive No. 2 LV"	36-33183-02			
	**Label, "Bus ID"	36-33183-03			
	**Label, "No. 2 LV"	36-33183-04			
					Ω

## PART NUMBER/DESCRIPTION INDEX

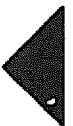

**INDEX BY DEC PART NUMBER  
B213F EXPANDER**

<b>PART NO.</b>	<b>DESCRIPTION</b>	<b>FIG NO.</b>	<b>ITEM NO.</b>
12-13756-A8	Cable Assembly, Ground	9A	6
12-17119-01	Keys, Front Panel	1	Not Shown
12-18672-00	Post Assembly, Locking	7	8
12-21249-06	Clip, Wire Routing	1A	8
12-26868-01	Screw, Thread Rolling Shoulder	2	11
12-26868-01	Screw, Thread Rolling Shoulder	4	5
12-27771-01	Screw, Slotted Shoulder Hd No. 6-32 x 1/2	10F	34
12-27771-01	Screw, Slotted Shoulder Hd No. 6-32 x 1/2	10A	21
12-27771-01	Screw, Slotted Shoulder Hd No. 6-32 x 1/2	10D	21
12-27771-01	Screw, Slotted Shoulder Hd No. 6-32 x 1/2	10B	27
12-27771-01	Screw, Slotted Shoulder Hd No. 6-32 x 1/2	10E	27
12-28756-19	Lens, Encoder Set	10E	29
12-28766-19	Lens, Encoder Set	10	12
12-28766-19	Lens, Encoder Set	6	10
12-28766-19	Lens, Encoder Set	10A	12
12-28766-19	Lens, Encoder Set	1	Not Shown
12-28766-19	Lens, Encoder Set	1	Not Shown
12-28976-01	Plug, Internal Terminator	10	11
12-28976-01	Terminator, Internal	10C	11
12-28976-01	Plug, Internal Terminator	6	9
12-29258-01	Terminator, External	10C	6
12-29258-01	Terminator, External	8A	5
12-29665-01	Screw, Shoulder No. 6-32 x 11/16	5	6
12-30421-01	Washer, Retaining (Replaces 12-27764-01)	5	5
12-33902-01	Protector, DSSI Port	1	23
17-00083-37	Cord, Power (US/Japan) (240V) (BN18T-4E)	9	5
17-00083-43	Cord, Power (US) (120V) (BN20A-2E)	9A	3
17-00083-43	Cord, Power (120V) (BN20A-2E)	9	2
17-00083-43	Cord, Power (120V) (BN20A-2E)	1	8
17-00083-44	Cord, Power (Japan) (240V) (BN20B-2E)	9A	4
17-00198-04	Cord, Power (Australia/New Zealand) (BN20C-2E) (240V)	9A	4
17-00198-05	Cord, Power (Australia/New Zealand) (240V) (BN18D-4E)	9	5
17-00199-07	Cord, Power (Austria, Belgium, (BN20D-2E) Czechoslovakia, France, Finland, Germany, Hungary, Netherlands, Norway, Poland, Portugal, Spain, Sweden, Switzerland) (240V)	9A	4
17-00199-10	Cord, Power (Austria, Belgium, France, Finland, Germany, Netherlands, Norway, Portugal, Spain, Sweden, Switzerland) (240V) (BN18C-4E)	9	5
17-00209-04	Cord, Power (UK/Ireland) (240V) (BN20E-2E)	9A	4
17-00209-05	Cord, Power (UK/Ireland) (240V) (BN18B-4E)	9	5
17-00210-04	Cord, Power (Switzerland) (240V) (BN20F-2E)	9A	4
17-00310-07	Cord, Power (Denmark) (240V) (BN20H-2E)	9A	4
17-00364-05	Cord, Power (Italy) (240V) (BN20J-2E)	9A	4
17-00364-06	Cord, Power (Italy/Switzerland) (240V) (BN18E-4E)	9	5



# **INDEX BY DEC PART NUMBER** **B213F EXPANDER**

<b>PART NO.</b>	<b>DESCRIPTION</b>	<b>FIG NO.</b>	<b>ITEM NO.</b>
17-00365-06	Cord, Power (240V)	1	8
17-00365-06	Cord, Power (240V)	9	3
17-00456-05	Cord, Power (India/South Africa) (240V) (BN20K-2E)	9A	4
17-00456-06	Cord, Power (India) (240V) (BN18H-4E)	9	5
17-00457-05	Cord, Power (Israel) (240V) (BN20L-2E)	9A	4
17-00457-06	Cord, Power (Israel) (240V) (BN18F-4E)	9	5
17-01252-03	Cable Assembly (BC21M-09)	10	16
17-01252-03	Cable Assembly, DSSI External (BC21M-09)	10C	16
17-01255-01	Cord, Power (Denmark) (240V) (BN18P-4E)	9	5
17-01360-01	Cable Assembly	1A	7
17-01836-01	Cable Assembly, Ribbon, 50 Pin Daisy Chain	1	Not Shown
17-01836-01	Cable Assembly, Ribbon, 50 Pin Daisy Chain	6	8
17-01836-01	Cable Assembly, Ribbon, 50 Pin Daisy Chain	10C	10
17-01836-01	Cable Assembly, Ribbon, 50 Pin Daisy Chain	10	10
17-01931-01	Cable Assembly, Round, 50 Conductor	10	2
17-01936-01	Cable Assembly, Ribbon, 10 Conductor	10B	28
17-01936-01	Cable Assembly, Ribbon, 10 Conductor	10D	22
17-01936-01	Cable Assembly, Ribbon, 10 Conductor	10A	22
17-01936-01	Cable Assembly, Ribbon, 10 Conductor	10F	35
17-01936-01	Cable Assembly, Ribbon, 10 Conductor	10E	28
17-01937-01	Harness Assembly, 5 Pin to 4 Pin Adaptor	10	17A
17-01937-01	Harness Assembly, 5 Pin to 4 Pin Adaptor	6	14
17-01937-01	Harness Assembly, 5 Pin to 4 Pin Adaptor	1	Not Shown
17-01937-01	Harness Assembly, 5 Pin to 4 Pin Adapter	10C	2
17-01964-01	Cable Assembly, Flat Ribbon, 10 Conductor	10C	3
17-01964-01	Cable Assembly, Flat Ribbon 10 Conductor	6	2
17-01964-01	Cable Assembly, Flat Ribbon, 10 Conductor	10	3
17-01964-01	Cable Assembly, Flat Ribbon, 10 Conductor	1	Not Shown
17-01989-01	Harness Assembly, Left Power	1	Not Shown
17-01989-01	Harness Assembly, Left Power	10	8
17-01989-01	Harness Assembly, Left Power	6	6
17-01989-01	Harness Assembly, Left Power	10C	8
17-01990-01	Harness Assembly, Right Power	10	9
17-01990-01	Harness Assembly, Right Power	6	7
17-01990-01	Harness Assembly, Right Power	1	Not Shown
17-01990-01	Harness Assembly, Right Power	10C	9
17-02152-03	Cable, Assembly DSSI (BC21M-09)	8	3
17-02152-03	Cable, Assembly DSSI (BC21M-09)	8A	4
17-02152-03	Cable Assembly, DSSI (BC21M-09)	1	3
17-02637-01	Cable Assembly, Power Sequence	9A	5
30-30166-01	Switch Assembly, Controlled Power (120V) (886-A)	9	4
30-30166-02	SWITCH ASSEMBLY, CONTROLLED POWER (240V) (886-B)	9	5

# **INDEX BY DEC PART NUMBER** **B213F EXPANDER**

<b>PART NO.</b>	<b>DESCRIPTION</b>	<b>FIG NO.</b>	<b>ITEM NO.</b>
36-12680-04	Label, "Ground" (Not Shown)	9A	11
36-17905-16	Label, "Warning Equipment Rating 100-120V"	1	Not Shown
36-17905-17	Label, "Warning Equipment Rating 220-240V"	1	Not Shown
36-18490-02	Label, "Switch Marker"	10G	Not Shown
36-18490-02	Label, "Switch Marker"	10H	Not Shown
36-20560-54	Label, "Do Not Expose"	5	7
36-26883-17	Label, "Module Number"	6	5
36-26883-17	Label, "Module Number"	10	7
36-26883-17	Label, "Module Number"	10C	7
36-27329-01	Label, "Serial/Model 100V"	1	Not Shown
36-27329-03	Label, "Serial/Model 220V"	1	Not Shown
36-27354-27	Label, "Logo/Model, B213F, Expander Box"	1	Not Shown
36-27838-01	Label, "Pedestal 11/53 USA 100V"	1	Not Shown
36-27838-37	Label, "Pedestal BA213, Made in US"	1	Not Shown
36-27924-01	Label, "Caution S-box Shipping"	1	Not Shown
36-29233-01	Label, "Wiring Diagram"	5	4
36-29341-01	Label, "Control Panel"	10	17
36-30973-01	Label, "Control Panel, R215F"	1	Not Shown
36-30973-01	Label, "Control Panel"	10C	13
36-30973-01	Label, "Control Panel"	6	11
36-30973-01	Label, "Control Panel"	10	13
36-33151-03	Label, "Bar Code"	10G	Not Shown
36-33151-03	Label, "Bar Code"	10H	Not Shown
36-33183-01	Label, "Drive Control"	10G	Not Shown
36-33183-01	Label, "Drive Control"	10H	Not Shown
36-33183-02	Label, "Drive No. 2 LV"	10G	Not Shown
36-33183-02	Label, "Drive No. 2 LV"	10H	Not Shown
36-33183-03	Label, "Bus ID"	10G	Not Shown
36-33183-03	Label, "Bus ID"	10H	Not Shown
36-33183-04	Label, "No. 2 LV"	10G	Not Shown
36-33183-04	Label, "No. 2 LV"	10H	Not Shown
47-00042-00	Screwdriver	1	Not Shown
47-00042-00	Screwdriver	1	Not Shown
54-17388-01	Module, DSSI BA200 Control	5	2
54-18247-01	Module, Drive	10D	23
54-18247-01	Module, Drive	10A	23
54-18247-01	Module, Drive	10E	30
54-18316-02	Module, Drive	10B	29
54-18316-02	Module, Drive	10F	36
70-23536-01	Mechanics, Drive	10A	23
70-23536-01	Mechanics, Drive	10E	30
70-23536-01	Mechanics, Drive	10D	23
70-23537-01	Mechanics, Drive	10F	36
70-23537-01	Mechanics, Drive	10B	29
70-23712-01	Backplane Assembly, BA213	1A	13
70-23769-01	Input Assembly, Filter	1A	10
70-23981-01	Bulkhead, Front Single	1	13
70-23981-04	Bulkhead Assembly, Front	1	4
70-23982-02	Bulkhead, Front Dual	1	11

# **INDEX BY DEC PART NUMBER** **B213F EXPANDER**

<b>PART NO.</b>	<b>DESCRIPTION</b>	<b>FIG NO.</b>	<b>ITEM NO.</b>
70-23996-01	Filler, Power Supply Assembly	1A	11
70-23998-01	Fan Assembly	1A	9
70-23999-01	Switch Assembly	1A	5
70-24037-01	ENCLOSURE ASSEMBLY, SHELL	1	9
70-24037-01	ENCLOSURE ASSEMBLY, SHELL	2	N/A
70-24041-01	PANEL ASSEMBLY, FRONT	3	N/A
70-24041-01	PANEL ASSEMBLY, FRONT	1	10
70-24046-01	BASE ASSEMBLY	4	N/A
70-24046-01	BASE ASSEMBLY	1	5
70-24227-03	ENCLOSURE ASSEMBLY, BA213 2 PS (120V)	1A	N/A
70-24227-03	ENCLOSURE ASSEMBLY, BA213 2 PS (120V)	1	1
70-24227-04	ENCLOSURE ASSEMBLY, BA213 2 PS (240V)	1	1
70-24227-04	ENCLOSURE ASSEMBLY, BA213 2 PS (240V)	1A	N/A
70-24255-01	Frame Assembly, BA213	1A	1
70-25452-01	Shock Assembly, Bottom	10D	19
70-25452-01	Shock Assembly, Bottom	10E	25
70-25452-01	Shock Assembly, Bottom	10A	19
70-25452-02	Shock Assembly, Top	10A	18
70-25452-02	Shock Assembly, Top	10D	18
70-25452-02	Shock Assembly, Top	10E	24
70-25452-03	Shock Assembly, Bottom	10F	32
70-25452-03	Shock Assembly, Bottom	10B	25
70-25452-03	Shock Assembly, Bottom	1	16
70-25452-04	Shock Assembly, Top	1	17
70-25452-04	Shock Assembly, Top	10B	24
70-25452-04	Shock Assembly, Top	10F	31
70-25721-01	Panel Assembly, Access	1A	14
70-25736-02	Bracket, Distribution (Weldment)	5	1
70-25750-01	Panel Assembly, Front (DSSI)	10	6
70-25750-02	Panel Assembly, Front (DSSI)	6	4
70-25750-02	Panel Assembly, Front (DSSI)	10	5
70-25750-02	Panel Assembly, Front (DSSI)	10C	5
70-25750-02	Panel Assembly, Front	1	12
70-25752-01	OCP Assembly	6	3
70-25752-01	OCP ASSEMBLY	1	21
70-25752-01	OCP Assembly	10	4
70-25752-01	OCP Assembly	10C	4
70-25752-01	OCP ASSEMBLY	5	N/A
70-25807-06	KIT, ACCESSORIES	1	Not Shown
70-25807-07	KIT, ACCESSORIES	1	Not Shown
70-26206-01	Plate Assembly, Connector	10C	14
70-26206-01	Plate Assembly, Connector	10	14
70-26206-01	Plate Assembly, Connector	6	12
70-26206-01	Plate Assembly, Connector	1	2
70-27049-04	Bezel, Disk Drive	10G	Not Shown
70-27049-04	Bezel, Disk Drive	10H	Not Shown
70-27458-01	Cable Assembly, DSSI Internal	10C	17
70-28086-01	Mounting Assembly, RF31 ISE	10G	Not Shown
70-28087-01	Mounting Assembly, RF71 ISE	10H	Not Shown

**INDEX BY DEC PART NUMBER  
B213F EXPANDER**

<b>PART NO.</b>	<b>DESCRIPTION</b>	<b>FIG NO.</b>	<b>ITEM NO.</b>
74-33646-01	Cover, Top	2	10
74-33647-01	Panel, Right Side	2	9
74-33648-01	Panel, Front	3	1
74-33650-01	Base, Lower	4	1
74-33651-01	Panel, Rear	2	4
74-33694-01	Panel, Left Side	2	5
74-33854-01	Fastener, Turn	1	15
74-33854-01	Fastener, Turn	4	8
74-34061-01	Door	3	3
74-34062-01	Channel, Front Panel	3	4
74-34063-01	Tumbler	3	11
74-34064-01	Latch, Pull	3	8
74-34065-01	Latch, Slide	3	9
74-34066-01	Spring, Channel	3	5
74-34067-01	Bezel, Switch	3	2
74-34068-01	Wheel, Base	4	2
74-34069-01	Shaft, Wheel	4	3
74-34123-01	Bracket, Top Right Hand	3	12
74-34123-02	Bracket, Top Left Hand	3	13
74-34124-01	Bracket, Bottom Right Hand	3	14
74-34124-02	Bracket, Bottom Left Hand	3	15
74-34125-01	Bracket, Side	2	2
74-34126-01	Bracket, Corner	2	1
74-34363-01	Stop, Door Position	3	6
74-34424-01	Sleeve	2	6
74-34425-37	Nameplate, B213F	1	20
74-34426-01	Logo	3	17
74-34846-01	Support, Label	4	6
74-35417-01	Switch, Frame	1	22
74-36425-01	Panel, 5 1/4" Tape Drive Filler	1	18
74-36498-01	Bracket, Bottom and Top Drive	10D	20
74-36498-01	Bracket, Bottom and Top Drive	10E	26
74-36498-01	Bracket, Bottom and Top Drive	10F	33
74-36498-01	Bracket, Bottom and Top Drive	10B	26
74-36498-01	Bracket, Bottom and Top Drive	10A	20
74-37040-01	Plate, Cover (added)	1A	16
90-00039-28	Screw, Mach Flat Hd No. 6-32 x 5/32	10D	21A
90-00039-28	Screw, Mach Flat Hd No. 6-32 x 5/32	10B	27A
90-00039-28	Screw, Machine Flat Hd No. 6-32 x 5/32	10F	34A
90-00039-28	Screw, Machine Flat Hd No. 6-32 x 5/32	10E	27A
90-00039-28	Screw, Mach Flat Hd No. 6-32 x 5/32	10A	21A
90-00063-13	Screw, Self Tap Phi Hd No. 6-32 x 5/16 (Replaces 90-00049-22)	5	3
90-00063-78	Screw, Self Tap Truss Hd No. 6 x 5/16	1A	15
90-01917-01	Screw, Metric	1	19
90-06024-03	Screw, Phi Truss Hd No. 6-32 x 1/2	9A	7
90-06565-00	Nut, Kep 10-32	9A	9
90-06661-00	Washer, Flat	2	7
90-06661-00	Washer, Flat	1	7

**INDEX BY DEC PART NUMBER**  
**B213F EXPANDER**

<b>PART NO.</b>	<b>DESCRIPTION</b>	<b>FIG NO.</b>	<b>ITEM NO.</b>
90-07032-00	Tie, Cable (deleted)	1A	4
90-07064-00	Plug, Button (added)	1A	12
90-07064-00	Plug, Button	1	14
90-07649-00	Washer, Self Lock	9A	8
90-08185-00	Nut, Kep No. 6-32 x 1/4 (added)	1A	17
90-08185-00	Nut, Kep No. 6-32	1A	6
90-08264-00	Clamp, Cable (deleted)	1A	3
90-09257-05	Ring, Retainer	3	10
90-09282-00	Screw, Sems Phl Pan Hd No. 10-32 x 5/16	4	9
90-09282-00	Screw, Sems Phl Pan Hd No. 10-32 x 5/16	1	Not Shown
90-09385-00	Pin, Roll	4	4
90-09800-04	Screw, Self-Tap Phl Pan Hd No. 8-16 X 3/8	2	3
90-09800-04	Screw, Self-Tap Phl Pan Hd No. 8-16 X 3/8	3	16
90-09800-06	Screw, Self-Tap Phl Pan Hd No. 6-19 x 3/8	3	7
90-09800-06	Screw, Self-Tap Phl Pan Hd No. 6-19 x 3/8	4	7
90-09800-08	Screw, Self-Tap Phl Pan Hd No. 8-16 x 1/2	1	6
90-09800-08	Screw, Self-Tap Phl Hd No. 8-16 x 1/2	2	8
90-10917-01	Screw, Mach Flat Hd (Metric No. 02.5 x .08)	10C	15
90-10917-01	Screw, Mach Flat Hd (Metric No. 02.5 x .08)	6	13
90-10917-01	Screw, Mach Flat Hd (Metric No. 02.5 x .08)	10	15
B213F	Expander	9	1
B213F	B213F Expander	8A	1
B213F	B213F Expander	8	1
B213F	B213F Expander	7	1
B213F	B213F Expander	9A	1
B213F-A2	B213F-A2 2 PS 120V w/o Skins	1	N/A
B213F-A3	B213F-A3 2 PS 240V w/o Skins	1	N/A
B213F-B2	B213F-B2 2 PS 120V w/Skins	1	N/A
B213F-B3	B213F-B3 2 PS 240V w/Skins	1	N/A
BC04V-09	Cable Assembly, Q-Bus	7	7
EK-431AA-IN	Expansion Installation Supplement (Not Shown)	9A	10
H4010-AA	KIT, SEQUENCING AND GROUNDING	9A	N/A
H7868-A	Power Supply Assembly, H7868-A 100/120V	1A	2
H7868-B	Power Supply Assembly, H7868-B 220/240V	1A	2
M9060-YA	Module, +5/12 Load	6	1
M9060-YA	Module, +5/12 Load	10C	1
M9060-YA	Module, +5/12 Load	10	1
M9404-PA	Module, Expander (J2 Conn)	7	6
M9404-PA	Module, Expander (J1 Conn)	7	5
M9405-PA	Module, Expander (J2 Conn)	7	4
M9405-PA	Module, Expander (J1 Conn)	7	3
MVXXXX	BA200/400 Host System	7	2
MVXXXX	BA200 Host System	8	2
MVXXXX	BA430 Host System	8A	2
MVXXXX	BA400 Host System	9A	2
MVXXXX	BA440 Host System	8A	3

**INDEX BY DEC PART NUMBER**  
**B213F EXPANDER**

<b>PART NO.</b>	<b>DESCRIPTION</b>	<b>FIG NO.</b>	<b>ITEM NO.</b>
N/A	B213F EXPANDER	1	N/A
N/A	B213F TO BA200/400 HOST SYSTEM w/Q-BUS CABLES	7	N/A
N/A	B213F FIELD UPGRADE INTERNAL DSSI CABLING	6	N/A
N/A	B213F TO BA200 HOST System w/DSSI CABLES	8	N/A
N/A	B213F TO BA400 HOST System w/DSSI CABLES	8A	N/A
N/A	DSSI CONFIGURATION, B213F TO BA200 HOST SYSTEM EXPANDED	10	N/A
N/A	DSSI CONFIGURATION, B213F TO BA400 HOST SYSTEM EXPANDED	10C	N/A
N/A	POWER CONNECTIONS/POWER CONTROL BUS CONNECTIONS, B213F TO BA400 HOST SYSTEM	9A	N/A
N/A	POWER CONNECTIONS, BA200 HOST SYSTEM AC	9	N/A
RF30-EA	DISK DRIVE, HALF HEIGHT w/o SKID PLATE	10A	23
RF30-EA	DISK DRIVE, HALF HEIGHT w/o SKID PLATE	10D	23
RF30E-SA	KIT, RF30 DISK DRIVE MOUNTING w/CABLES	10A	N/A
RF30E-SA	KIT, RF30 DISK DRIVE MOUNTING w/CABLES (INSTALLED IN BA200 SERIES ONLY)	10D	N/A
RF31-EA	DISK DRIVE, 381 MB	10E	30
RF31E-AA	STORAGE ELEMENT, RF31E (INSTALLED IN BA200 SERIES ONLY)	10G	N/A
RF31E-SA	KIT, RF31 DISK DRIVE MOUNTING w/CABLES (INSTALLED IN BA200 SERIES ONLY)	10E	N/A
RF71-EA	DISK DRIVE, w/o SKID PLATE	10B	29
RF71-EA	DISK DRIVE, w/o SKID PLATE	10F	36
RF71E-AA	STORAGE ELEMENT, RF71E (INSTALLED IN BA400 SERIES ONLY)	10H	N/A
RF71E-SA	KIT, RF71 DISK DRIVE MOUNTING w/CABLES	10B	N/A
RF71E-SA	KIT, RF71 DISK DRIVE MOUNTING w/CABLE (INSTALLED IN BA200 SERIES ONLY)	10F	10C

# **INDEX BY DEC PART DESCRIPTION** **B213F EXPANDER**

DESCRIPTION	DEC PART NO.	FIG. NO.	ITEM NO.
B213F EXPANDER	N/A	1	N/A
B213F Expander	B213F	9A	1
B213F Expander	B213F	7	1
B213F Expander	B213F	8	1
B213F Expander	B213F	8A	1
B213F Expander	B213F	9	1
B213F FIELD UPGRADE INTERNAL DSSI CABLING	N/A	6	N/A
B213F TO BA200 HOST Sysstem w/DSSI CABLES	N/A	8	N/A
B213F TO BA200/400 HOST SYSTEM w/Q-BUS CABLES	N/A	7	N/A
B213F TO BA400 HOST System w/DSSI CABLES	N/A	8A	N/A
 B213F-A2 2 PS 120V w/o Skins	 B213F-A2	 1	 N/A
B213F-A3 2 PS 240V w/o Skins	B213F-A3	1	N/A
B213F-B2 2 PS 120V w/Skins	B213F-B2	1	N/A
B213F-B3 2 PS 240V w/Skins	B213F-B3	1	N/A
BA200 Host System	MVXXXX	8	2
BA200/400 Host System	MVXXXX	7	2
BA400 Host System	M'XXXX	9A	2
BA430 Host System	MVXXXX	8A	2
BA440 Host System	MVXXXX	8A	3
Backplane Assembly, BA213	70-23712-01	1A	13
 BASE ASSEMBLY	 70-24046-01	 1	 5
BASE ASSEMBLY	70-24046-01	4	N/A
Base, Lower	74-33650-01	4	1
Bezel, Disk Drive	70-27049-04	10G	N/A
Bezel, Disk Drive	70-27049-04	10H	N/A
Bezel, Switch	74-34067-01	3	2
Bracket, Bottom and Top Drive	74-36498-01	10B	26
Bracket, Bottom and Top Drive	74-36498-01	10F	33
Bracket, Bottom and Top Drive	74-36498-01	10E	26
Bracket, Bottom and Top Drive	74-36498-01	10D	20
Bracket, Bottom and Top Drive	74-36498-01	10A	20
 Bracket, Bottom Left Hand	 74-34124-02	 3	 15
Bracket, Bottom Right Hand	74-34124-01	3	14
Bracket, Corner	74-34126-01	2	1
Bracket, Distribution (Weldment)	70-25736-02	5	1
Bracket, Side	74-34125-01	2	2
Bracket, Top Left Hand	74-34123-02	3	13
Bracket, Top Right Hand	74-34123-01	3	12
Bulkhead Assembly, Front	70-23981-04	1	4
Bulkhead, Front Dual	70-23982-02	1	11
Bulkhead, Front Single	70-23981-01	1	13
 Cable Assembly	 17-01360-01	 1A	 7
Cable Assembly (BC21M-09)	17-01252-03	10	16
Cable Assembly, 10 Cond Flat 2 ft	17-01964-01	1	Not Shown
Cable Assembly, DSSI External (BC21M-09)	17-01252-03	10C	16

**INDEX BY DEC PART DESCRIPTION  
B213F EXPANDER**

DESCRIPTION	DEC PART NO.	FIG. NO.	ITEM NO.
Cable Assembly, DSSI External (BC21M-09)	17-02152-03	1	3
Cable Assembly, DSSI Internal	70-27458-01	10C	17
Cable Assembly, Flat 50 Cond	17-01836-01	1	Not Shown
Cable Assembly, Flat Ribbon, 10 Conductor	17-01964-01	6	2
Cable Assembly, Flat Ribbon, 10 Conductor	17-01936-01	10B	28
Cable Assembly, Flat Ribbon, 10 Conductor	17-01964-01	10C	3
Cable Assembly, Flat Ribbon, 10 Conductor	17-01936-01	10A	22
Cable Assembly, Flat Ribbon, 10 Conductor	17-01964-01	10	3
Cable Assembly, Flat Ribbon, 50 Pin Daisy Chain	17-01836-01	10	10
Cable Assembly, Flat Ribbon, 50 Pin Daisy Chain	17-01836-01	6	8
Cable Assembly, Ground	12-13756-A8	9A	6
Cable Assembly, Power Sequence	17-02637-01	9A	5
Cable Assembly, Q-Bus	BC04V-09	7	7
Cable Assembly, Ribbon, 10 Conductor	17-01936-01	10F	35
Cable Assembly, Ribbon, 10 Conductor	17-01936-01	10B	28
Cable Assembly, Ribbon, 10 Conductor	17-01936-01	10D	22
Cable Assembly, Ribbon, 50 Pin Daisy Chain	17-01936-01	10C	10
Cable Assembly, Round, 50 Conductor	17-01931-01	10	2
Cable Assembly, DSSI (BC21M-09)	17-02152-03	8A	4
Cable Assembly, DSSI (BC21M-09)	17-02152-03	8	3
Channel, Front Panel	74-34062-01	3	4
Clamp, Cable (deleted)	90-08264-00	1A	3
Clip, Wire Routing	12-21249-06	1A	8
Cord, Power (120V) (BN20A-2E)	17-00083-43	9	2
Cord, Power (120V) (BN20A-2E)	17-00083-43	1	8
Cord, Power (240V)	17-00365-06	9	3
Cord, Power (240V)	17-00365-06	1	8
Cord, Power (Australia/New Zealand) (240V) (BN18D-4E)	17-00198-05	9	5
Cord, Power (Australia/New Zealand) (240V) (BN20C-2E)	17-00198-04	9A	4
Cord, Power (Austria, Belgium, (BN20D-2E) Czechoslovakia, France, Finland, Germany, Hungary, Netherlands, Norway, Poland, Portugal, Spain, Sweden, Switzerland (240V)	17-00199-07	9A	4
Cord, Power (Austria, Belgium, France (BN18C-4E) Finland, Germany, Netherlands, Norway, Portugal, Spain, Sweden, Switzerland) (240V)	17-00199-10	9	5
Cord, Power (Denmark) (240V) (BN18P-4E)	17-01255-01	9	5
Cord, Power (Denmark) (240V) (BN20H-2E)	17-00310-07	9A	4
Cord, Power (India) (240V) (BN18H-4E)	17-00456-06	9	5
Cord, Power (India/South Africa) (240V) (BN20K-2E)	17-00456-05	9A	4
Cord, Power (Israel) (240V) (BN18F-4E)	17-00457-06	9	5
Cord, Power (Israel) (240V) (BN20L-2E)	17-00457-05	9A	4
Cord, Power (Italy) (240V) (BN20J-2E)	17-00364-05	9A	4
Cord, Power (Italy/Switzerland) (240V) (BN18E-4E)	17-00364-06	9	5
Cord, Power (Japan) (240V) (BN20B-2E)	17-00083-44	9A	4
Cord, Power (Switzerland) (240V) (BN20F-2E)	17-00210-04	9A	4
Cord, Power (UK/Ireland) (240V) (BN18B-4E)	17-00209-05	9	5
Cord, Power (UK/Ireland) (240V) (BN20E-2E)	17-00209-04	9A	4



# **INDEX BY DEC PART DESCRIPTION** **B213F EXPANDER**

DESCRIPTION	DEC PART NO.	FIG. NO.	ITEM NO.
Cord, Power (US) (120V) (BN20A-2E)	17-00083-43	9A	3
Cord, Power (US/Japan) (240V) (BN18T-4E)	17-00083-37	9	5
Cover, Top	74-33646-01	2	10
DISK DRIVE, 381 MB	RF31-EA	10E	30
DISK DRIVE, HALF HEIGHT w/o SKID PLATE	RF30-EA	10A	23
DISK DRIVE, HALF HEIGHT w/o SKID PLATE	RF30-EA	10D	23
DISK DRIVE, w/o SKID PLATE	RF71-EA	10B	29
DISK DRIVE, w/o SKID PLATE	RF71-EA	10F	36
Door	74-34061-01	3	3
DSSI CONFIGURATION, B213F TO BA200 HOST SYSTEM EXPANDED	N/A	10	N/A
DSSI CONFIGURATION, B213F TO BA400 HOST SYSTEM EXPANDED	N/A	10C	N/A
ENCLOSURE ASSEMBLY, BA213 2 PS (120V)	70-24227-03	1A	N/A
ENCLOSURE ASSEMBLY, BA213 2 PS (240V)	70-24227-04	1A	N/A
ENCLOSURE ASSEMBLY, BA213 2 PS (120V)	70-24227-03	1	1
ENCLOSURE ASSEMBLY, BA213 2 PS (240V)	70-24227-04	1	1
ENCLOSURE ASSEMBLY, SHELL	70-24037-01	1	9
ENCLOSURE ASSEMBLY, SHELL	70-24037-01	2	N/A
Expansion Installation Supplement (Not Shown)	EK-431AA-IN	9A	10
Fan Assembly	70-23998-01	1A	9
Fastener, Turn	74-33854-01	4	8
Fastener, Turn	74-33854-01	1	15
Filler, Power Supply Assembly	70-23998-01	1A	11
Frame Assembly, BA213	70-24255-01	1A	1
Harness Assembly, 10 Cond	17-01989-01	1	Not Shown
Harness Assembly, 10 Cond	17-01990-01	1	Not Shown
Harness Assembly, 5 Pin to 4 Pin Adapter	17-01937-01	10C	2
Harness Assembly, 5 Pin to 4 Pin Adaptor	17-01937-01	6	14
Harness Assembly, 5 Pin to 4 Pin Adaptor	17-01937-01	10	17A
Harness Assembly, Left Power	17-01989-01	10C	8
Harness Assembly, Left Power	17-01989-01	6	6
Harness Assembly, Left Power	17-01989-01	10	8
Harness Assembly, Right Power	17-01990-01	10C	9
Harness Assembly, Right Power	17-01990-01	10	9
Harness Assembly, Right Power	17-01990-01	6	7
Harness Assembly, Wire 18 AWG	17-01937-01	1	Not Shown
Input Assembly, Filter	70-23769-01	1A	10
Keys, Front Panel	12-17119-01	1	Not Shown
KIT, ACCESSORIES	70-25807-06	1	Not Shown
KIT, ACCESSORIES	70-25807-07	1	Not Shown
KIT, RF30 DISK DRIVE MOUNTING w/CABLES (INSTALLED IN BA200 SERIES ONLY)	RF30E-SA	10D	N/A
KIT, RF30 DISK DRIVE MOUNTING w/CABLES	RF30E-SA	10A	N/A
KIT, RF31 DISK DRIVE MOUNTING w/CABLES (INSTALLED IN BA200 SERIES ONLY)	RF31E-SA	10E	N/A
KIT, RF71 DISK DRIVE MOUNTING w/CABLE	RF71E-SA	10B	N/A
KIT, RF71 DISK DRIVE MOUNTING w/CABLES (INSTALLED IN BA200 SERIES ONLY)	RF71E-SA	10F	N/A

**INDEX BY DEC PART DESCRIPTION  
B213F EXPANDER**

DESCRIPTION	DEC PART NO.	FIG. NO.	ITEM NO.
<b>KIT, SEQUENCING AND GROUNDING</b>	<b>H4010-AA</b>	<b>9A</b>	<b>N/A</b>
Label, "Bar Code"	36-33151-03	10G	Not Shown
Label, "Bar Code"	36-33151-03	10H	Not Shown
Label, "Bus ID"	36-33183-03	10G	Not Shown
Label, "Bus ID"	36-33183-03	10H	Not Shown
Label, "Caution S-box Shipping"	36-27924-01	1	Not Shown
Label, "Control Panel"	36-29341-01	10	17
Label, "Control Panel"	36-30973-01	10C	13
Label, "Control Panel"	36-30973-01	6	11
Label, "Control Panel"	36-30973-01	10	13
Label, "Control Panel"	36-30973-01	1	Not Shown
Label, "Do Not Expose"	36-20560-54	5	7
Label, "Drive Control"	36-33183-01	10G	Not Shown
Label, "Drive Control"	36-33183-01	10H	Not Shown
Label, "Drive No. 2 LV"	36-33183-02	10G	Not Shown
Label, "Drive No. 2 LV"	36-33183-02	10H	Not Shown
Label, "Ground" (Not Shown)	36-12680-04	9A	11
Label, "Logo/Model, B213F, Expander Box"	36-27354-27	1	Not Shown
Label, "Module Number"	36-26883-17	10C	7
Label, "Module Number"	36-26883-17	10	7
Label, "Module Number"	36-26883-17	6	5
Label, "No. 2 LV"	36-33183-04	10G	Not Shown
Label, "No. 2 LV"	36-33183-04	10H	Not Shown
Label, "Pedestal 11/53 USA 100V"	36-27838-01	1	Not Shown
Label, "Pedestal BA213, Made in US"	36-27838-37	1	Not Shown
Label, "Serial/Model 100V"	36-27329-01	1	Not Shown
Label, "Serial/Model 220V"	36-27329-03	1	Not Shown
Label, "Switch Marker"	36-18490-02	10G	Not Shown
Label, "Switch Marker"	36-18490-02	10H	Not Shown
Label, "Warning Equipment Rating 100-120V"	36-17905-16	1	Not Shown
Label, "Warning Equipment Rating 220-240V"	36-17905-17	1	Not Shown
Label, "Wiring Diagram"	36-29233-01	5	4
Latch, Pull	74-34064-01	3	8
Latch, Slide	74-34065-01	3	9
Lens, Encoder Set	12-28766-19	1	Not Shown
Lens, Encoder Set	12-28766-19	1	Not Shown
Lens, Encoder Set	12-28766-19	10C	12
Lens, Encoder Set	12-28766-19	10E	29
Lens, Encoder Set	12-28766-19	10	12
Lens, Encoder Set	12-28766-19	6	10
Logo	74-34426-01	3	17
Mechanics, Drive	70-23537-01	10B	29
Mechanics, Drive	70-23536-01	10E	30
Mechanics, Drive	70-23536-01	10D	23
Mechanics, Drive	70-23537-01	10F	36
Mechanics, Drive	70-23536-01	10A	23
Module, +5/12 Load	M9060-YA	10	1
Module, +5/12 Load	M9060-YA	10C	1
Module, +5/12 Load	M9060-YA	6	1
Module, Drive	54-18247-01	10B	29
Module, Drive	54-18316-02	10E	30

# **INDEX BY DEC PART DESCRIPTION** **B213F EXPANDER**

DESCRIPTION	DEC PART NO.	FIG. NO.	ITEM NO.
Module, Drive	54-18316-02	10F	36
Module, Drive	54-18247-01	10A	23
Module, Drive	54-18247-01	10D	23
Module, DSSI BA200 Control	54-17388-01	5	2
Module, Expander (J1 Conn)	M9405-PA	7	3
Module, Expander (J1 Conn)	M9404-PA	7	5
Module, Expander (J2 Conn)	M9405-PA	7	4
Module, Expander (J2 Conn)	M9404-P/	7	6
Mounting Assembly, RF31 ISE	70-28085-01	10C	Not Shown
Mounting Assembly, RF71 ISE	70-28087-01	10C	Not Shown
Nameplate, B213F	74-34425-37	1	20
Nut, Kep 10-32	90-06565-00	9A	9
Nut, Kep No. 6-32	90-08185-00	1A	6
OCP Assembly	70-25752-01	10	4
OCP Assembly	70-25752-01	10C	4
OCP Assembly	70-25752-01	6	3
OCP ASSEMBLY	70-25752-01	5	N/A
OCP ASSEMBLY	70-25752-01	1	21
Panel Assembly, Access	70-25721-01	1A	14
Panel Assembly, Front	70-25750-02	1	12
PANEL ASSEMBLY, FRONT	70-24041-01	3	N/A
PANEL ASSEMBLY, FRONT	70-24041-01	1	10
Panel Assembly, Front (DSSI)	70-25750-02	10C	5
Panel Assembly, Front (DSSI)	70-25750-02	6	4
Panel Assembly, Front (DSSI)	70-25750-01	10	6
Panel Assembly, Front (DSSI)	70-25750-02	10	5
Panel, 5 1/4" Tape Drive Filler	74-36425-01	1	18
Panel, Front	74-33648-01	3	1
Panel, Left Side	74-33694-01	2	5
Panel, Rear	74-33651-01	2	4
Panel, Right Side	74-33647-01	2	9
Pin, Roll	90-09385-00	4	4
Plate Assembly, Connector	70-26206-01	10C	14
Plate Assembly, Connector	70-26206-01	1	2
Plate Assembly, Connector	70-26206-01	10	14
Plate Assembly, Connector	70-26206-01	6	12
Plate, Cover (added)	74-37040-01	1A	16
Plug, Button	90-07064-00	1	14
Plug, Button (added)	90-07064-00	1A	12
Plug, Internal Terminator	12-28976-01	6	9
Plug, Internal Terminator	12-28976-01	10	11
Post Assembly, Locking	12-18672-00	7	8
POWER CONNECTIONS, BA200 HOST SYSTEM AC	N/A	9	N/A
POWER CONNECTIONS/POWER CONTROL BUS			
CONNECTIONS, B213F TO BA400 HOST SYS	N/A	9A	N/A
Power Supply Assembly, H7868-A 100/120V	H7868-A	1A	2
Power Supply Assembly, H7868-B 220/240V	H7868-B	1A	2
Protector, DSSI Port	12-33902-01	1	23

**INDEX BY DEC PART DESCRIPTION**  
**B213F EXPANDER**

DESCRIPTION	DEC PART NO.	FIG. NO.	ITEM NO.
Ring, Retainer	90-09257-05	3	10
Screw, Mach Flat Hd (Metric No. 02.5 x .08)	90-10917-01	10C	15
Screw, Mach Flat Hd (Metric No. 02.5 x .08)	90-10917-01	6	13
Screw, Mach Flat Hd (Metric No. 02.5 x .08)	90-10917-01	10	15
Screw, Mach Flat Hd No. 6-32 x 5/32	90-00039-28	10B	27A
Screw, Mach Flat Hd No. 6-32 x 5/32	90-00039-28	10A	21A
Screw, Mach Flat Hd No. 6-32 x 5/32	90-00039-28	10D	21A
Screw, Mach Flat Hd No. 6-32 x 5/32	90-00039-28	10F	34A
Screw, Mach Flat Hd No. 6-32 x 5/32	90-00039-28	10E	27A
Screw, Metric	90-01917-01	1	19
Screw, Phi Truss Hd No. 6-32 x 1/2	90-06024-03	9A	7
Screw, Self-Tap Phi Hd No. 6-32 x 5/16 (Replaces 90-00049-22)	90-00063-13	5	3
Screw, Self-Tap Phi Hd No. 8-16 x 1/2	90-09800-08	2	8
Screw, Self-Tap Phi Pan Hd No. 8-16 x 3/8	90-09800-04	3	16
Screw, Self-Tap Truss Hd No. 6 x 5/16	90-00063-78	1A	15
Screw, Self-Tap Phi Pan Hd No. 6-19 x 3/8	90-09800-06	3	7
Screw, Self-Tap Phi Pan Hd No. 8-16 x 1/2	90-09800-08	1	6
Screw, Self-Tap Phi Pan Hd No. 8-16 x 3/8	90-09800-04	2	3
Screw, Self-Tap Phi Pan Hd No. 6-19 x 3/8	90-09800-06	4	7
Screw, Sems Phi Pan Hd No. 10-32 x 5/16	90-09282-00	4	9
Screw, Shoulder No. 6-32 x 11/16	12-29665-01	5	6
Screw, Slotted Shoulder Hd No. 6-32 x 1/2	12-27771-01	10AF	34
Screw, Slotted Shoulder Hd No. 6-32 x 1/2	12-27771-01	10A	21
Screw, Slotted Shoulder Hd No. 6-32 x 1/2	12-27771-01	10B	27
Screw, Slotted Shoulder Hd No. 6-32 x 1/2	12-27771-01	10E	27
Screw, Slotted Shoulder Hd No. 6-32 x 1/2	12-27771-01	10D	21
Screw, Thread Rolling Shoulder	12-26868-01	4	5
Screw, Thread Rolling Shoulder	12-26868-01	2	11
Screw, Sems Phi Pan Hd No. 10-32 x 15/16	90-09282-00	1	Not Shown
Screwdriver	47-00042-00	1	Not Shown
Screwdriver	47-00042-00	1	Not Shown
Shaft, Wheel	74-34069-01	4	3
Shock Assembly, Bottom	70-25452-03	10F	32
Shock Assembly, Bottom	70-25452-01	10E	25
Shock Assembly, Bottom	70-25452-01	10A	19
Shock Assembly, Bottom	70-25452-03	10B	25
Shock Assembly, Bottom	70-25452-01	10D	19
Shock Assembly, Bottom	70-25452-03	1	16
Shock Assembly, Top	70-25452-02	10E	24
Shock Assembly, Top	70-25452-02	10A	18
Shock Assembly, Top	70-25452-04	10F	31
Shock Assembly, Top	70-25452-02	10B	18
Shock Assembly, Top	70-25452-04	10D	24
Shock Assembly, Top	70-25452-04	1	17

**INDEX BY DEC PART DESCRIPTION  
B213F EXPANDER**

<b>DESCRIPTION</b>	<b>DEC PART NO.</b>	<b>FIG. NO.</b>	<b>ITEM NO.</b>
Sleeve	74-34424-01	2	6
Spring, Channel	74-34068-01	3	5
Stop, Door Position	74-34383-01	3	6
STORAGE ELEMENT, RF31E (INSTALLED IN BA400 SERIES ONLY)	RF31E-AA	10G	N/A
STORAGE ELEMENT, RF71E (INSTALLED IN BA400 SERIES ONLY)	RF71E-AA	10G	N/A
Support, Label	74-34846-01	4	6
Switch Assembly	70-23999-01	1A	5
SWITCH ASSEMBLY, CONTROLLED POWER (120V) (886-A)	30-30166-01	9	4
SWITCH ASSEMBLY, CONTROLLED POWER (240V) (886-B)	30-30166-02	9	5
Switch, Frame	74-35417-01	1	22
Terminator, External	12-29258-01	10C	6
Terminator, External	12-29258-01	8A	5
Terminator, Internal	12-28976-01	10C	11
Tie, Cable (deleted)	90-07032-00	1A	4
Tumbler	74-34063-01	3	11
Washer, Flat	90-06661-00	2	7
Washer, Flat	90-06661-00	1	7
Washer, Retaining (Replaces 12-27764-01)	12-30421-01	5	5
Washer, Self Lock	90-07649-00	9A	8
Wheel, Base	74-34068-01	4	2