

6. Unplug the 4-wire power cable from the back of the tape drive (Figure 6-4).
7. Pull the tape drive cable straight out of the back of the tape drive.
8. Slide the tape drive out of the chassis. If the drive has to be returned, use the replacement tape drive's shipping carton.

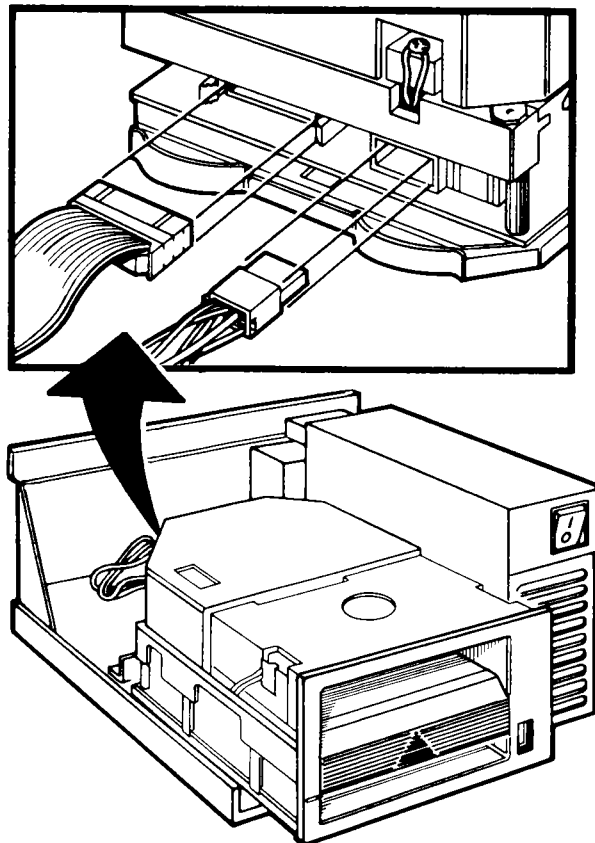

MR-15365
SHR-0415-85

Figure 6-4 Remove the Power Cable and Drive Cables